



03-SERIES

**2-ROW & 6-ROW  
PEANUT  
VINE LIFTERS  
(4 X 4 & 5 X 5)**

**OPERATOR MANUAL  
AND  
PARTS BOOK**

*THIS MANUAL TO ACCOMPANY MACHINE*



PART NO. 03-MP-05  
Printing Date MAY 2017

# WARRANTY POLICY

KELLEY MANUFACTURING COMPANY (KMC) warrants that all goods sold to the original purchaser of any KMC product shall be free of any defects in material and workmanship if used under normal operating conditions. The warranty period begins on the date of purchase by the retail customer and ends twelve (12) months thereafter. KMC's sole responsibility is to repair and/or replace the defective part or parts at no cost to purchaser. This remedy is the **SOLE AND EXCLUSIVE REMEDY** of purchaser.

The purchaser must fill out and return the warranty registration form found in the front of the operator's manual. Failure to return the warranty registration form within 30 days shall result in the goods being sold "AS IS", and all warranties shall be excluded.

This warranty shall not apply to those items that are by nature worn in normal service, including but not limited to belts, springs, teeth, chains, etc. Items such as tires, tubes, and gearboxes and all other items warranted by the original manufacturer are warranted only to the extent of their individual manufacturer warranty, and KMC is not warranting any of said items. All warranty claims must be made through a KMC licensed dealer, and a warranty form request must be submitted to KMC within 30 days of failure or the warranty provision shall be unenforceable against KMC.

No agent or person has authority to change or add to this warranty as written.

THE ABOVE IS THE ONLY WARRANTY MADE BY KMC AND IS MADE EXPRESSLY IN LIEU OF ALL OTHER WARRANTIES, EXPRESSED OR IMPLIED. KMC MAKES NO WARRANTY OF MERCHANTABILITY AS TO ANY GOODS MANUFACTURED BY KMC AND FURTHER, KMC DOES NOT WARRANT ANY SUCH GOODS AS SUITABLE FOR ANY PARTICULAR PURPOSE TO THE RETAIL CUSTOMER. THE SUITABILITY OF GOODS FOR ANY PURPOSE PARTICULAR TO THE CUSTOMER IS FOR THE CUSTOMER, IN HIS SOLE JUDGEMENT, TO DETERMINE. KMC FURTHER MAKES NO WARRANTIES WITH RESPECT TO ITS MANUFACTURED GOODS THAT WOULD NORMALLY BE DISCLOSED BY AN EXAMINATION. THIS IS THE FULL AND FINAL EXPRESSION OF ALL WARRANTY LIABILITY OF KMC. NO OTHER WARRANTY, EITHER EXPRESSED OR IMPLIED, SHALL BE ENFORCEABLE AGAINST KMC.

**Kelley Manufacturing Co.**

80 Vernon Drive / Zip 31794  
P.O. Drawer 1467 / Zip 31793  
Tifton GA



# ***VINE LIFTER OWNERS MANUAL***

## **Table of Contents:**

### **FORWARD**

Introduction .....	3
To the Purchaser .....	3
Pre-Operational Check List .....	4

### **SAFETY**

Symbol Information .....	5
Safety Decals .....	6
Retail Customers Responsibility under the KMC Warranty .....	7
Safety Procedures .....	7-8

### **ASSEMBLY SET-UP**

General: .....	9-10
2R & 6R (4 x 4) ◇ Vine Lifter Layouts .....	12-13
2R, 6R & 8R (5 x 5) Vine Lifter Layouts .....	14-16
Bolt Torque Chart .....	17
Leveling the Machine .....	18
Mounting Blades and Cut Rods .....	18

### **OPERATIONAL SET-UP**

Tractor Preparation:	
Front End Weights .....	19
Horsepower Requirements .....	19
Wheel Spacing .....	19
Drawbar Position .....	19
Hitching to the Implement: .....	20
Storage Tips for Machine .....	20

### **PARTS BOOK SECTION**

#### **4 X 4 ◇ Vine Lifters:**

2-Row Vine Lifter (Model 03-2L) .....	22
6-Row Vine Lifter (Model 03-6L) .....	23

#### **2 & 6-Row Vine Lifter Tool Bars & Hitches For 4 x 4 ◇ Bars:**

Lower Hitch-Vine Lifter .....	24
Mast-Vine Lifter .....	24
Vine Lifter Tool Bars .....	25
DB Vine Lifter Bracket .....	25

#### **5 x 5 Vine Lifters:**

2-Row Vine Lifter (Model 03-2RVL) .....	26
6-Row Vine Lifter (Model 03-6R(30)VL & 03-6R(36-40)VL) .....	27
8-Row Vine Lifter (Model 03-8(30)VL) .....	28-29

## **2R, 6R & 8R Vine Lifter Tool Bars & Hitches For 5 x 5 Bars:**

<b>(5 x 5 ) Bolt-on Mast .....</b>	<b>30</b>
<b>(5 x 5) Bolt-on Hitches .....</b>	<b>31</b>
<b>(5 x 5) Tool Bars .....</b>	<b>31</b>
<b>Manual Canister .....</b>	<b>31</b>

## **Plow Shanks:**

<b>4 x 4 ◇ Shanks .....</b>	<b>32</b>
<b>5 x 5 Shanks .....</b>	<b>33</b>

## **26" Frogs:**

<b>For 4 x 4 ◇ Bars .....</b>	<b>34</b>
<b>For 5 x 5 Bars .....</b>	<b>34</b>

## **Blades & Cut Rods**

<b>For 4 x 4 ◇ Bars .....</b>	<b>35</b>
<b>For 5 x 5 Bars .....</b>	<b>35</b>

## **Gauge Wheel Components:**

<b>1 x 3 Shank Bracket, 4 x 4 ◇ .....</b>	<b>36</b>
<b>1 x 3 Shank Bracket, 4 x 4 ◇ .....</b>	<b>37</b>
<b>1 x 3 Shank Bracket, 5 x 5 .....</b>	<b>37</b>
<b>5 X 5 to 4 x 4 Bracket .....</b>	<b>38</b>
<b>Lt &amp; Rt Inverter Gauge Wheel Arm .....</b>	<b>40-41</b>
<b>Tire &amp; Rim Assembly (9.5L-15) .....</b>	<b>41</b>
 <b>Safety Reflectors .....</b>	 <b>42</b>

# FORWARD

## INTRODUCTION:

The **KMC VINE LIFTER** is designed to be operated from the stationary drawbar of the tractor. It can be operated from a lower lift arm drawbar if a stationary bar is not available. The unit comes equipped with a hydraulic cylinder to raise and lower the cutter blade (this will require a set of remote hydraulic couplers on the tractor). When attaching to the stationary drawbar of the tractor, you should set the distance from the end of the tractor PTO to the center of the hitch pin hole at 14 inches. If your tractor has an option of a 540 or 1000 RPM PTO you should install the 540 shaft.

## TO THE PURCHASER

This **KMC VINE LIFTER** has been carefully designed and manufactured to give years of dependable service. In order to operate it efficiently and maintain it properly, please read the instructions within this manual thoroughly.

Some components of this machine are labeled left or right. The notations are determined by standing behind the implement and facing the direction of forward travel.

After reading this Operator's Manual, Please keep it for reference each season.

To insure procurement of the proper repair parts, please record your machine's Model Number, Serial Number, and Purchase Date as shown below:

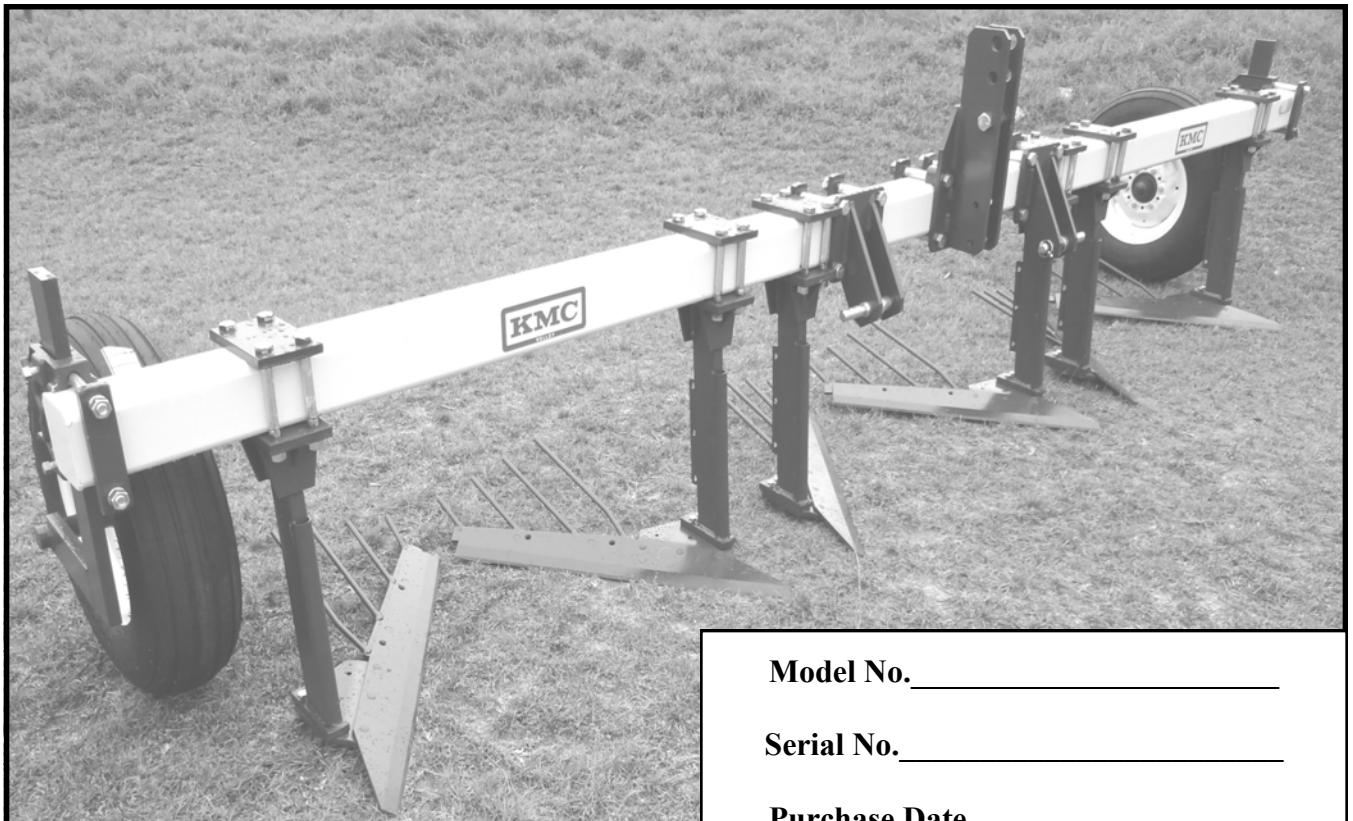

Model No. \_\_\_\_\_

Serial No. \_\_\_\_\_

Purchase Date \_\_\_\_\_

## **PRE-OPERATIONAL CHECKLIST:**

- ☐ All safety and operating procedures reviewed
- ☐ All hardware checked for tightness
- ☐ Hitch connection to implement information reviewed
- ☐ Field adjustment procedures reviewed
- ☐ Lubrication information reviewed
- ☐ Machine fully lubricated
- ☐ Warranty information reviewed

# SAFETY

## SYMBOL INFORMATION



This safety alert symbol is used throughout this manual to identify safety messages. When you see this symbol, read the message which follows as it will advise you of possible injury.

**REMEMBER**

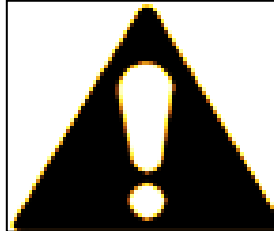

**THINK SAFETY!**



**(RED)**

This symbol indicates an imminently hazardous situation that, if not avoided, will result in death or serious injury.



**(ORANGE)**

This symbol indicates a potentially hazardous situation that, if not avoided, could result in death or serious injury. It may also be used to alert against unsafe practices.



**(YELLOW)**

This symbol indicates a potentially hazardous situation that, if not avoided, may result in minor or moderate injury. It may also be used to alert against unsafe practices.



**(GREEN  
OR  
BLACK)**

Is used for instruction on operating, adjusting, or servicing a machine.

***BEING SAFETY CONSCIOUS IS GOOD BUSINESS!***

## **SAFETY DECALS**

The Safety decals that follow are associated with the implement covered in this owner's manual. They should be reviewed and associated with where they are applicable on the implement being covered.

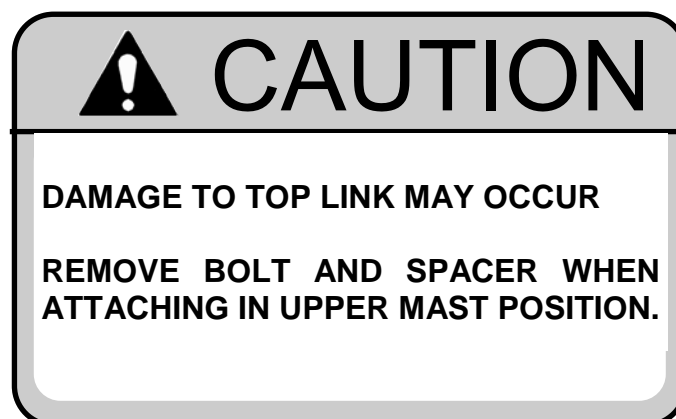
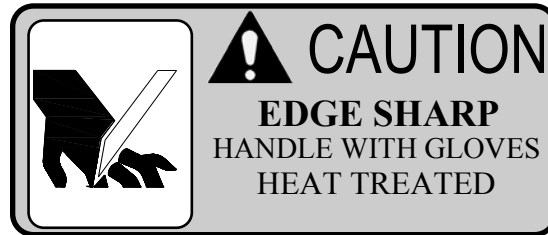



## **RETAIL CUSTOMERS RESPONSIBILITY UNDER THE KMC WARRANTY:**

### **The retail customer's responsibilities are:**

1. To read the Operator's Manual and operate the **KMC VINE LIFTER** in accordance with the instructions given in this manual.
2. To inspect the **KMC VINE LIFTER** daily, lubricate as specified and repair or replace parts as needed, especially when continued use would cause damage or excessive wear to other parts.
3. To maintain and keep in place all safety shields, decals and devices.
4. When warranty service is necessary, it is the customer's responsibility to deliver the machine to the KMC dealer from which it was purchased. Warranty repairs should be submitted to the dealer within **thirty (30)** days of failure.
5. Dealer travel to the machine or hauling the machine to his shop for the purpose of performing warranty service is not allowed under KMC warranty. It is a cost to be paid for by the retail customer. Any arrangement whereby the dealer agrees to absorb all or part of this cost is strictly between the dealer and the retail customer.

## **SAFETY PROCEDURES:**

Safety and performance are the primary objectives of the designers of KMC equipment. Safety features have been incorporated into this machine where possible and warnings given in other areas. For your safety, **PLEASE** read and observe the following safety procedures.

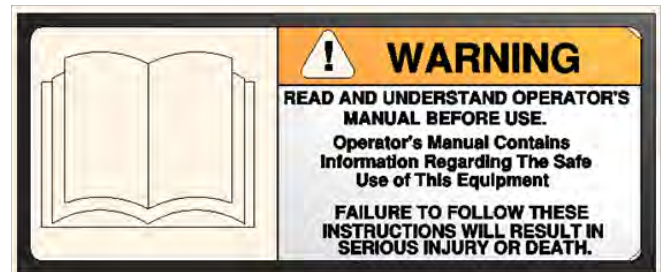

1. All persons operating this piece of equipment should **READ** the Owner's Manual.



2. Do not permit anyone to ride on the machine at any time.
3. Before starting or operating the machine, make a walk-around inspection and check for obvious defects such as loose mounting bolts and damaged components. Correct any deficiencies before starting. **(The equipment must be properly maintained and guarded and must be suitable to performing its task.)**



4. Keep all persons a safe distance away from all sides of the machine while it is in operation.

5. **Do not allow children to operate the KMC VINE LIFTER . Only experienced tractor operators should operate the tractor when the KMC VINE LIFTER is in use.**
6. Stay clear of hydraulic lines, as they maybe under extreme pressure or heat.
7. Drive safely during transport; excessive speed while turning or on rough ground could cause damage to the **KMC VINE LIFTER** and/or cause the tractor to tip over. **(Maximum speed of implement should never exceed 20 mph on highway and 10 mph off-highway.)**
8. Make sure hitch components are attached securely before operating or transporting.
9. Use flashing warning lights when on highways, except where prohibited by law.
10. Disengage PTO, apply parking brake, and stop tractor engine before dismounting tractor. Allow mechanisms to stop completely before cleaning, working, or adjusting on machine. Even when the tractor is stationary, you should make sure it is properly secured and made safe by following the **Safe Stop procedure:**
  1. **Handbrake/Footbrake on**
  2. **Controls in neutral/park**
  3. **Engine off**
  4. **Key out**
11. Keep hands, feet and clothing away from moving parts.
12. Make sure everyone is clear of machine before starting tractor or operating machine.
13. Observe all safety decals located on machine. Replace them if they become damaged.

## **HIGH VOLTAGE SAFETY ACT**

Georgia Law requires that anyone operating equipment within 10 feet of an overhead high voltage line of more than 750 volts, must contact the Utilities Protection Center (UPC) by telephone at least 72 hours before commencing the work. For more information call (811), toll free (1-800-282-7411) or visit on the web “[www.gaupc.com](http://www.gaupc.com)”. **Please** contact your local power company about laws before operating near high voltage lines.

# ASSEMBLY SET-UP

## GENERAL:

Throughout this manual we will be discussing various features and components of the **KMC VINE LIFTER**. References to various components for adjustments, settings, performance, and lubrication are made. The following chart will help you **IDENTIFY** those areas of discussion for better understanding and discussion with your dealer and representative as the need arises.

## KMC VINE LIFTER BASIC FEATURES

**4 X 4 DIAMOND BAR**

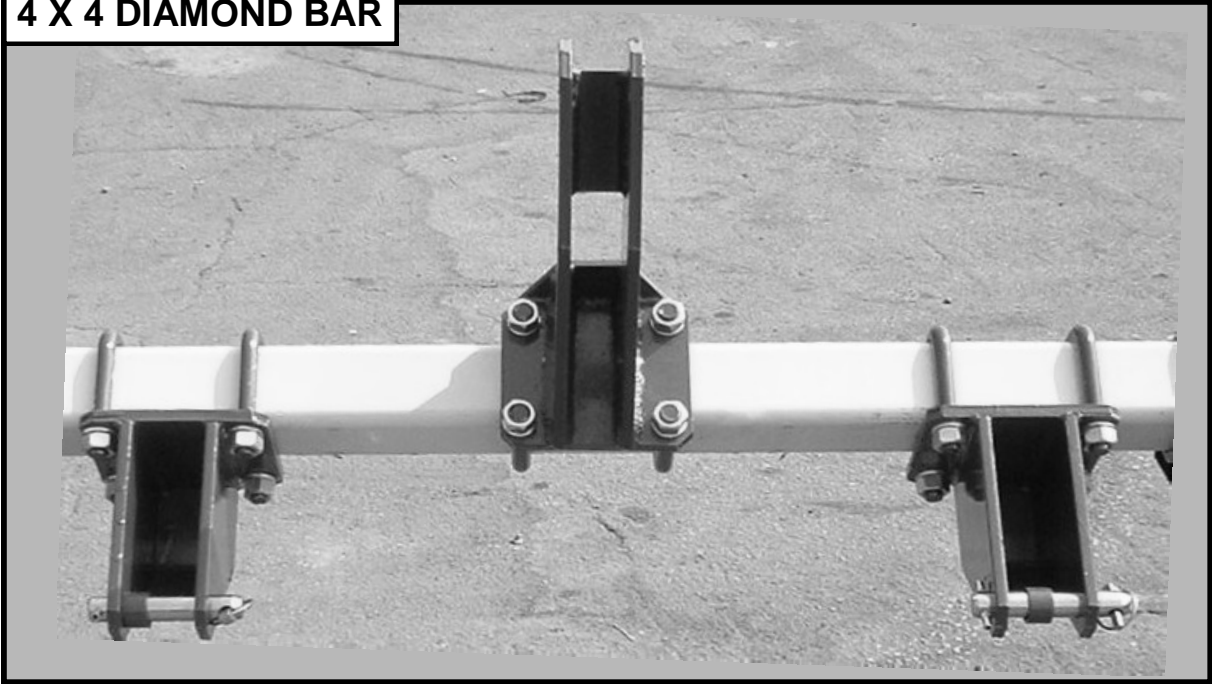

**5 X 5 SQUARE BAR**





## WARNING

CARE SHOULD BE TAKEN DURING SET-UP AND ASSEMBLY OF THIS PRODUCT. DEATH OR SERIOUS INJURY COULD OCCUR IF PROPER STEPS ARE NOT TAKEN TO FULLY SECURE THE UNIT WHEN WORKING UNDERNEATH IT. FOR YOUR SAFETY, ENSURE THE UNIT IS PROPERLY SUPPORTED BY LOWERING THE JACKSTAND SUPPORTS THAT HAVE COME ASSEMBLED WITH IT, OR PROPERLY SECURE THE UNIT WITH ANY HOISTING DEVICES BEFORE ATTEMPTING ANY FURTHER SET-UP OF THIS PRODUCT. ANY HOISTING DEVICES SHOULD BE RATED TO FULLY SUPPORT THE LOAD OF THE UNIT BEING LIFTED.

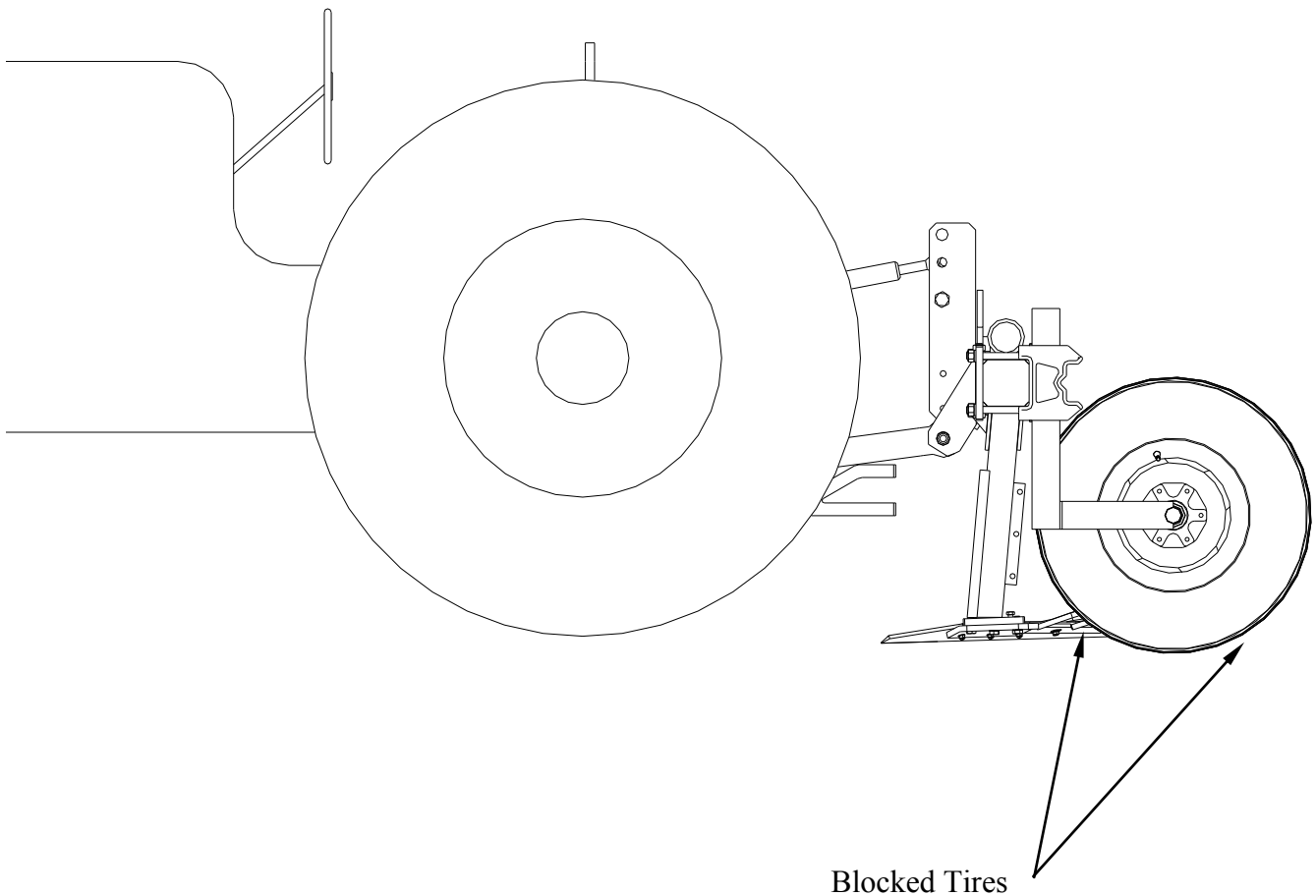

# **VINE LIFTER LAYOUTS**



## 2-ROW 4 X 4 DIAMOND VINE LIFTER

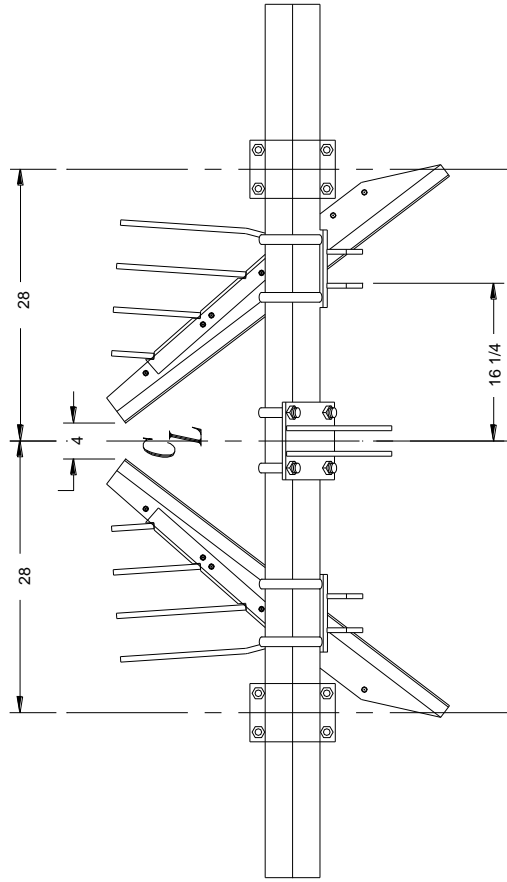

## 6-36-38 ROW 4 X 4 DIAMOND VINE LIFTER

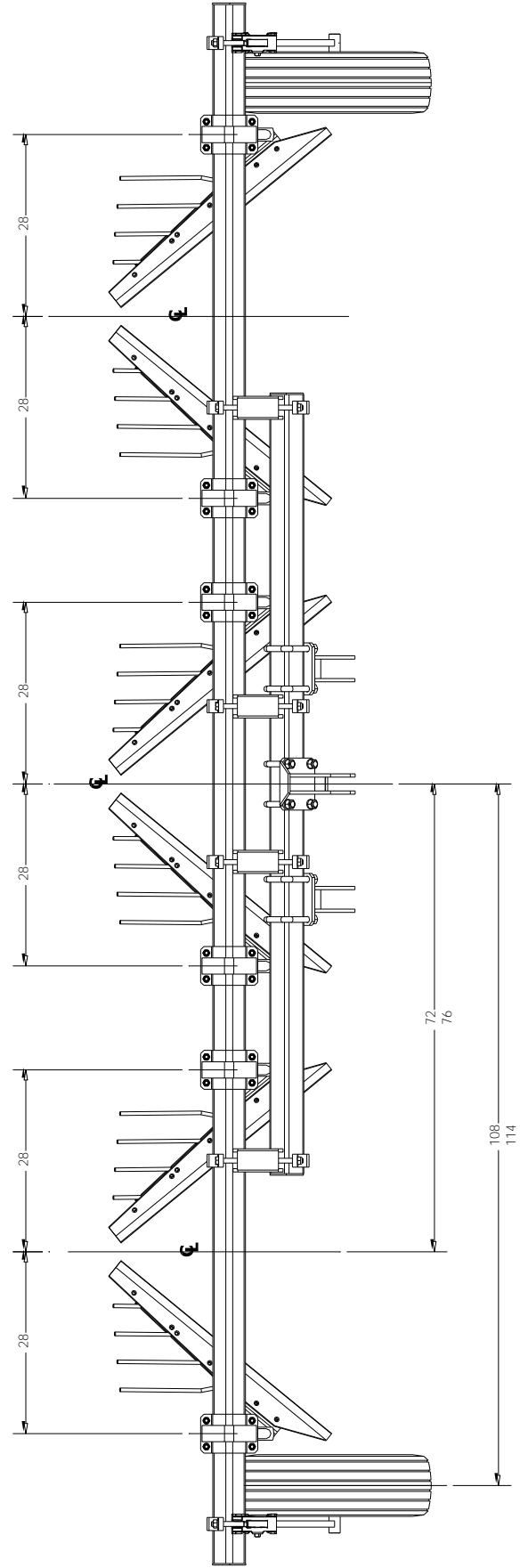

Technical drawing of a 120-inch long metal frame assembly. The drawing shows a side view of the structure with various dimensions and labels.

**Dimensions:**

- Overall length: 120"
- Section lengths: 80" (twice), 57 15/16" (TYP)
- Vertical dimensions: 28" (multiple times), 12" (TYP), 16 1/4" (TYP)

**Labels:**

- A**: Motor or actuator at the top and bottom.
- B**: Vertical support or bracket.
- C**: Diagonal support or bracket.
- D**: Horizontal support or bracket.
- E**: Small vertical pin or fastener.
- F**: Small horizontal pin or fastener.
- G**: Small vertical pin or fastener.
- H**: Small horizontal pin or fastener.
- I**: Small vertical pin or fastener.
- J**: Small horizontal pin or fastener.
- K**: Small vertical pin or fastener.
- L**: Small horizontal pin or fastener.
- M**: Small vertical pin or fastener.
- N**: Small horizontal pin or fastener.
- O**: Small vertical pin or fastener.
- P**: Small horizontal pin or fastener.
- Q**: Small vertical pin or fastener.
- R**: Small horizontal pin or fastener.
- S**: Small vertical pin or fastener.
- T**: Small horizontal pin or fastener.
- U**: Small vertical pin or fastener.
- V**: Small horizontal pin or fastener.
- W**: Small vertical pin or fastener.
- X**: Small horizontal pin or fastener.
- Y**: Small vertical pin or fastener.
- Z**: Small horizontal pin or fastener.

## 2-ROW 5 X 5 VINE LIFTER

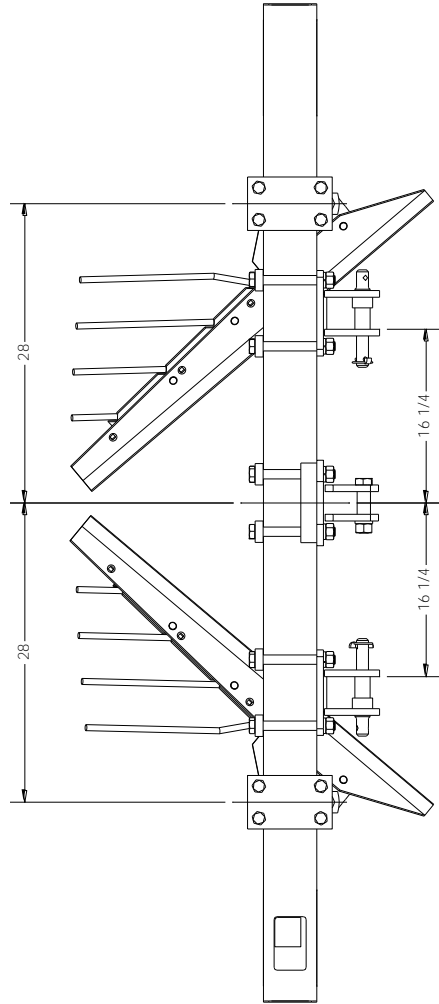

## 6-30 ROW 5 X 5 VINE LIFTER

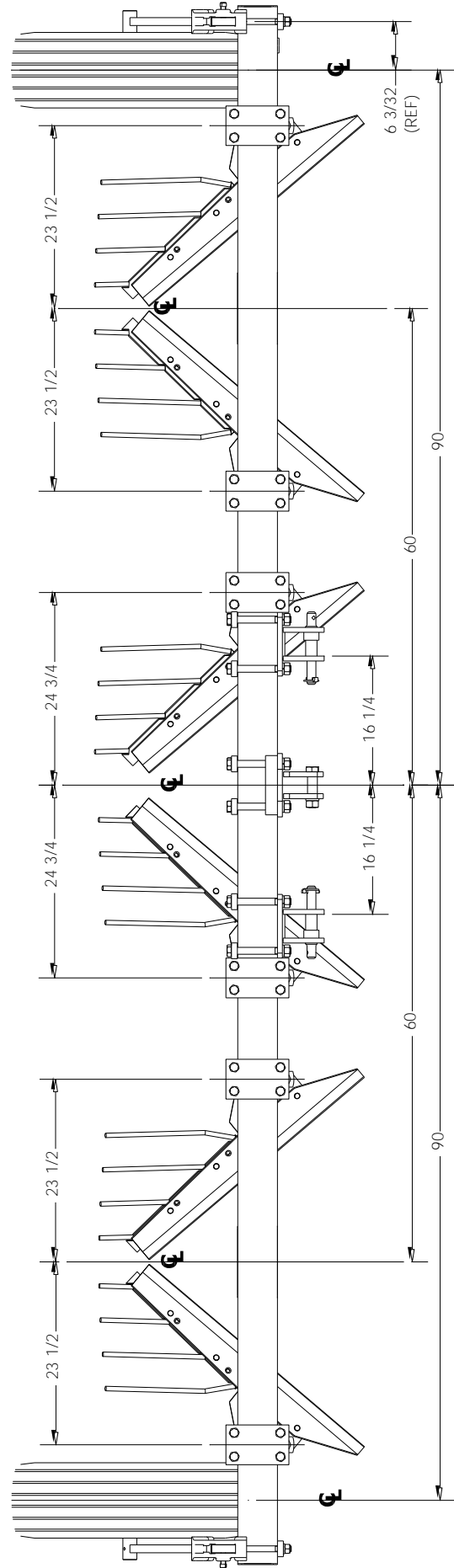

**6-36-38 ROW 5 X 5 VINE LIFTER**

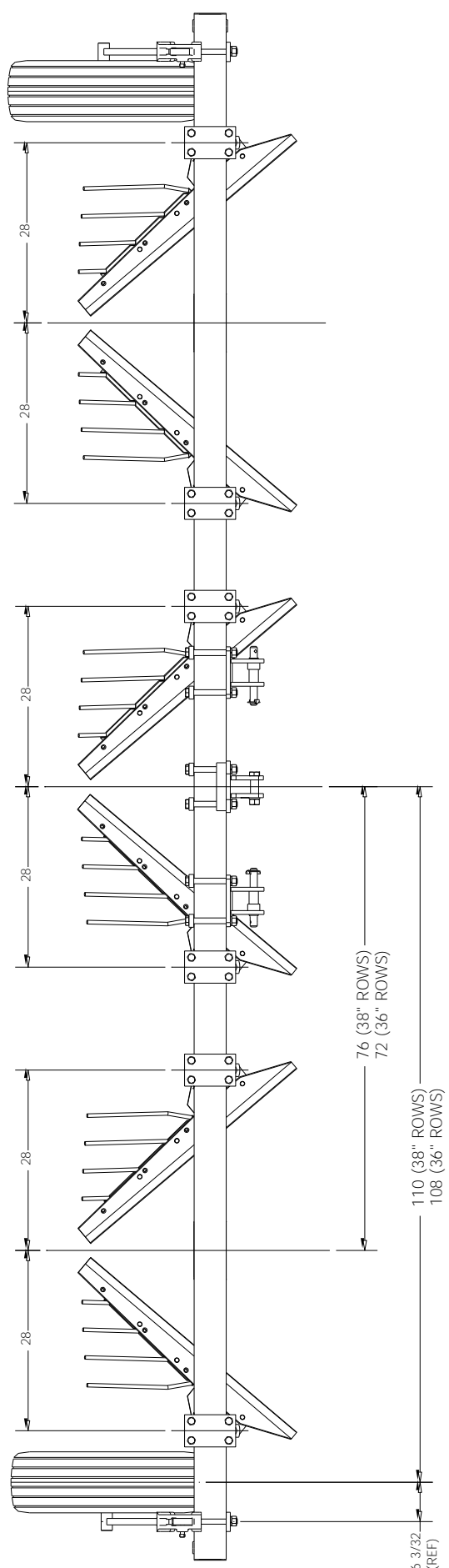

**6-40 ROW 5 X 5 VINE LIFTER**

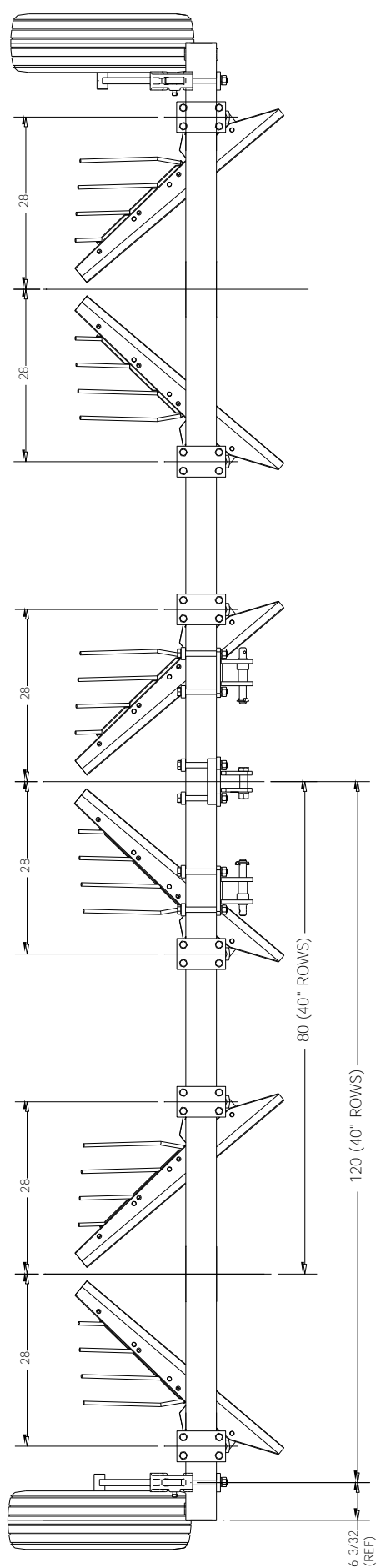

8-30 ROW 5 X 5 VINE LIFTER

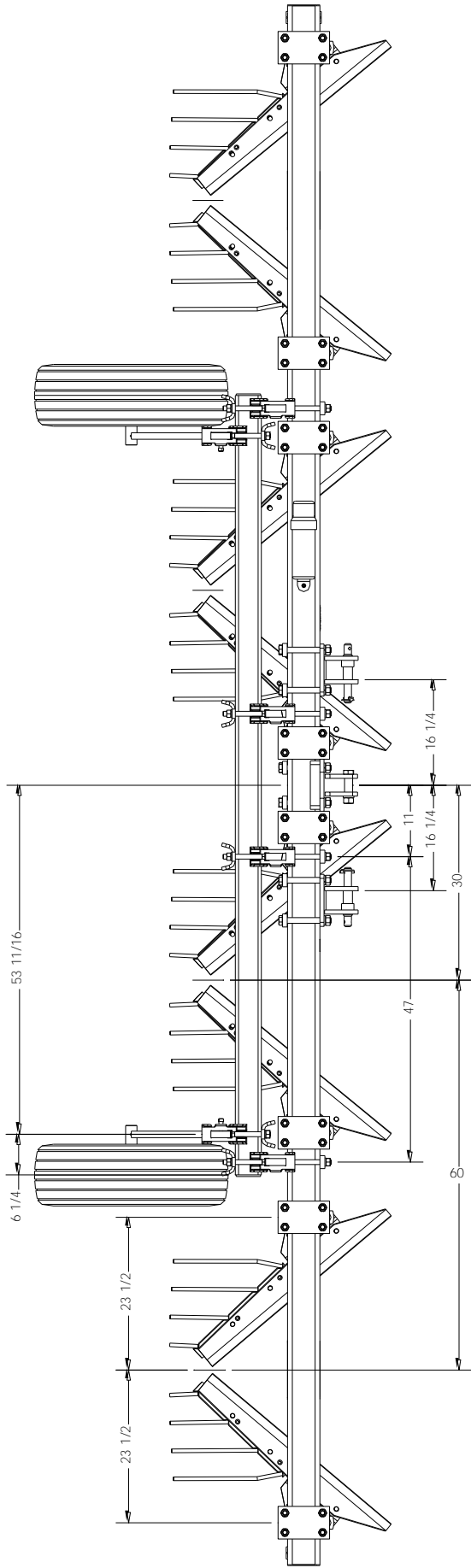



# ! IMPORTANT !

Before set-up and assembly can be completed ensure that all hardware is in place and fully tightened. Refer to the **Bolt Torque Chart** below for proper torque values.

## BOLT TORQUE CHART

## SAE GRADE 5



DIAMETER & THREADS PER INCH	TENSILE STRENGTH MIN. PSI	PROOF LOAD LB	CLAMP LOAD LB	TORQUE DRY FT LB	LUBRICATED FT LB
1/4-20	120,000	2,700	2,020	8	6.3
1/4-28	120,000	3,100	2,320	10	7.2
5/16-18	120,000	4,450	3,340	17	13
5/16-24	120,000	4,900	3,700	19	14
3/8-16	120,000	6,600	4,950	30	23
3/8-24	120,000	7,450	5,600	35	25
7/16-14	120,000	9,050	6,780	50	35
7/16-20	120,000	10,100	7,570	55	40
1/2-13	120,000	12,100	9,050	75	55
1/2-20	120,000	13,600	10,200	85	65
9/16-12	120,000	15,500	11,600	110	80
9/16-18	120,000	17,300	12,950	120	90
5/8-11	120,000	19,200	14,400	150	110
5/8-18	120,000	21,800	16,350	170	130
3/4-10	120,000	28,400	21,300	260	200
3/4-16	120,000	31,700	23,780	300	220
7/8-9	120,000	39,300	29,450	430	320
7/8-14	120,000	43,300	32,450	470	350
1-8	120,000	51,500	38,600	640	480
1-14	120,000	57,700	43,300	720	540

## SAE GRADE 8



DIAMETER & THREADS PER INCH	TENSILE STRENGTH MIN. PSI	PROOF LOAD LB	CLAMP LOAD LB	TORQUE DRY FT LB	LUBRICATED FT LB
1/4-20	150,000	3,800	2,850	12	9
1/4-28	150,000	4,350	3,250	14	10
5/16-18	150,000	6,300	4,700	24	18
5/16-24	150,000	6,950	5,200	27	20
3/8-16	150,000	9,300	6,980	45	35
3/8-24	150,000	10,500	7,900	50	35
7/16-14	150,000	12,800	9,550	70	50
7/16-20	150,000	14,200	10,650	80	60
1/2-13	150,000	17,000	12,750	110	80
1/2-20	150,000	19,200	14,400	120	90
9/16-12	150,000	21,800	16,350	150	110
9/16-18	150,000	24,400	18,250	170	130
5/8-11	150,000	27,100	20,350	210	160
5/8-18	150,000	30,700	23,000	240	180
3/4-10	150,000	40,100	30,100	380	280
3/4-16	150,000	44,800	33,500	420	310
7/8-9	150,000	55,400	41,600	600	450
7/8-14	150,000	61,100	45,800	670	500
1-8	150,000	72,700	54,500	910	680
1-14	150,000	81,500	61,100	1,020	760

## Leveling the Machine:

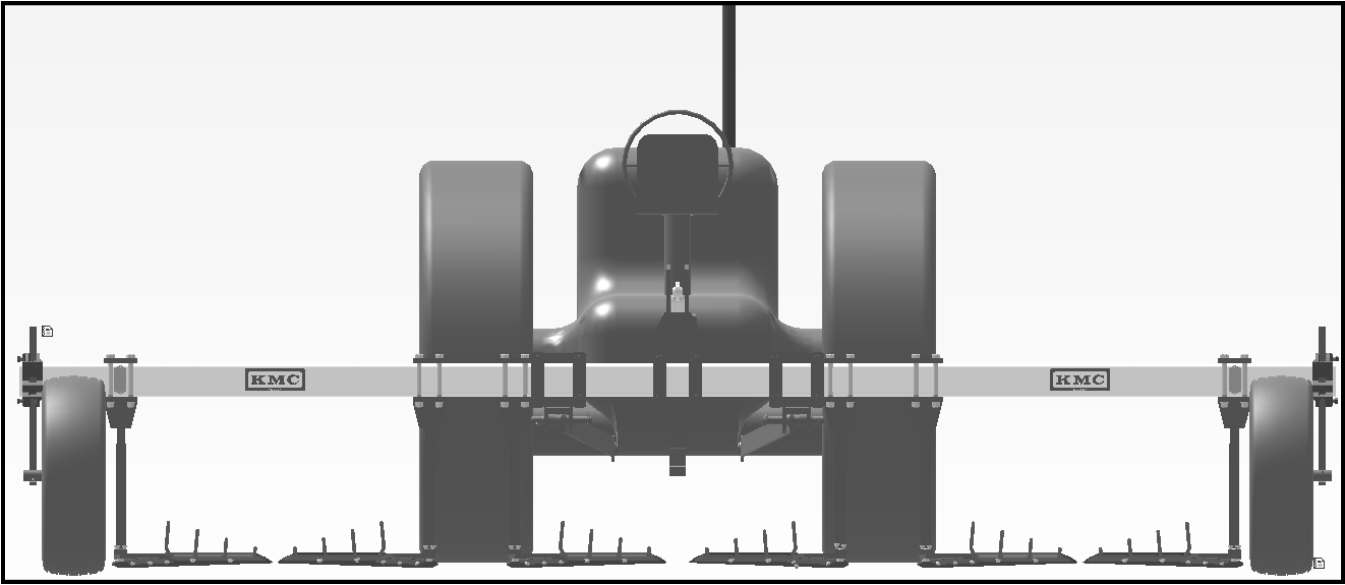

Hitch Implement to the tractor three-point hitch.

Leveling the machine is best accomplished by placing tractor and unit on a level surface, preferably on a concrete slab. Make sure rear tire inflation pressure is the same on both rear tractor tires. Level the machine by standing at the rear of the machine with the implement raised and sight top of tool bar with top of tractor axle. Adjust lift arms until front tool bar is parallel with tractor axle.

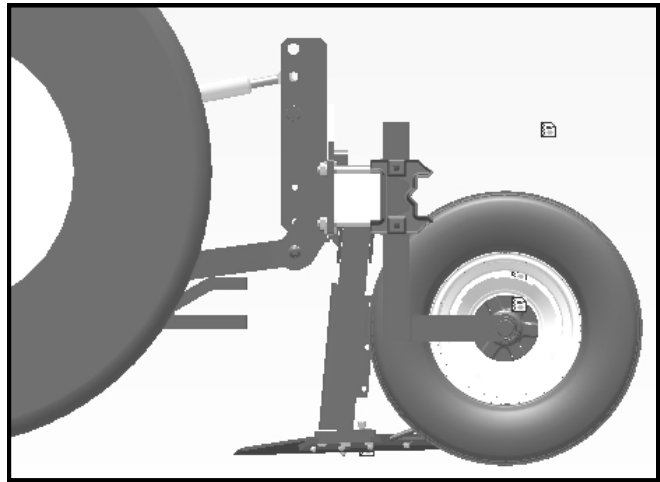

## Mounting Blades and Cut Rods:

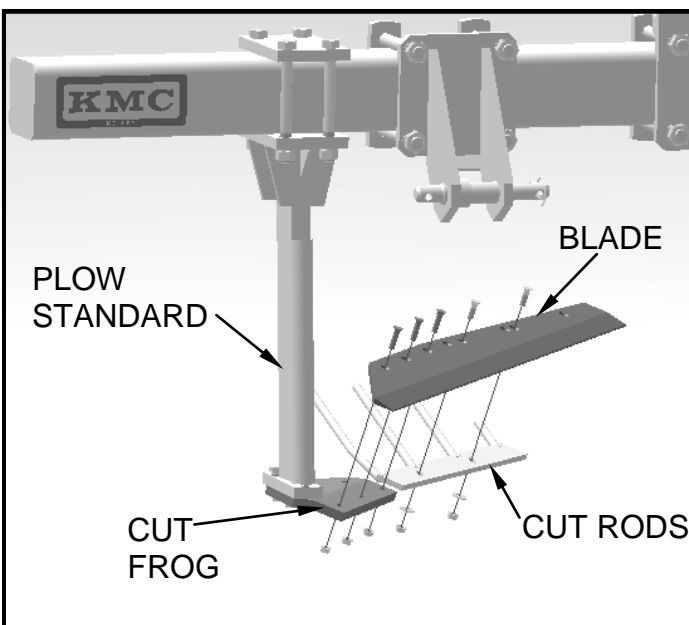

First mount the blade to the cut frog which has already been assembled to the plow standard. Connect the blade to the frog with three 3/8" x 1 1/2" plow bolt, grd "8", lockwasher, and hex nut. Left and right blades are assembled the same way. Next, mount the cut rods to the blade using two 3/8" x 1 1/4" reg plow bolt, washer, and hex nut.



**CAUTION:** PEANUT BLADES HAVE A SHARP EDGE WHICH CAN CAUSE SERIOUS INJURY. USE GLOVES AND HANDLE WITH CARE WHEN CHANGING OR ADJUSTING BLADES.

# OPERATIONAL SETUP

## **TRACTOR PREPARATION:**

Before operating implement refer to tractor operator's manual for information concerning safe methods of operation, hydraulics, hitch adjustment, tire inflation, wheel adjustments and tractor weights.

Check tractor brakes and warning lights, make sure they are in proper working order.

Check tractor hydraulics oil reservoir and add oil if needed.



### **WARNING**

**TRANSPORTING THE IMPLEMENT WILL ADD SIGNIFICANT WEIGHT TO YOUR TRACTOR. MAKE SURE THE TRACTOR IS PROPERLY BALLASTED.**

### **Front-End Weights:**

Use front-end weights as needed to provide effective steering control and front-end stability.

See your tractors Operator's Manual for recommendations on ballasting procedures.



### **WARNING**

**DO NOT EXCEED THE TRACTOR'S LIFT CAPACITY OR BALLAST RECOMMENDATIONS.**

### **Horse Power Requirements:**

The minimum power requirement for the 2-Row is 30 HP, 6-Row is 70 HP, & 8-Row is 100 HP depending on soil type. Select a tractor with sufficient power to operate these machines.

### **Wheel Spacing**

Set tractor wheels so they are equally spaced from center of tractor and centered between the rows. See your Tractor Operator's Manual for correct tire inflation pressure.

### **Drawbar Position**

Place the drawbar in the center position to keep combine in the center of the rows.

## **Hitching to the Tractor:**

This machine is designed to help vines dry faster by lifting the rows of peanuts off the ground to allow the vines to dry out. They also help to break up crusty conditions and free peanuts for the wet sticky soil.

The Vine Lifter is design to work on Category II, III and Category III Quick Hitch (wide & narrow).

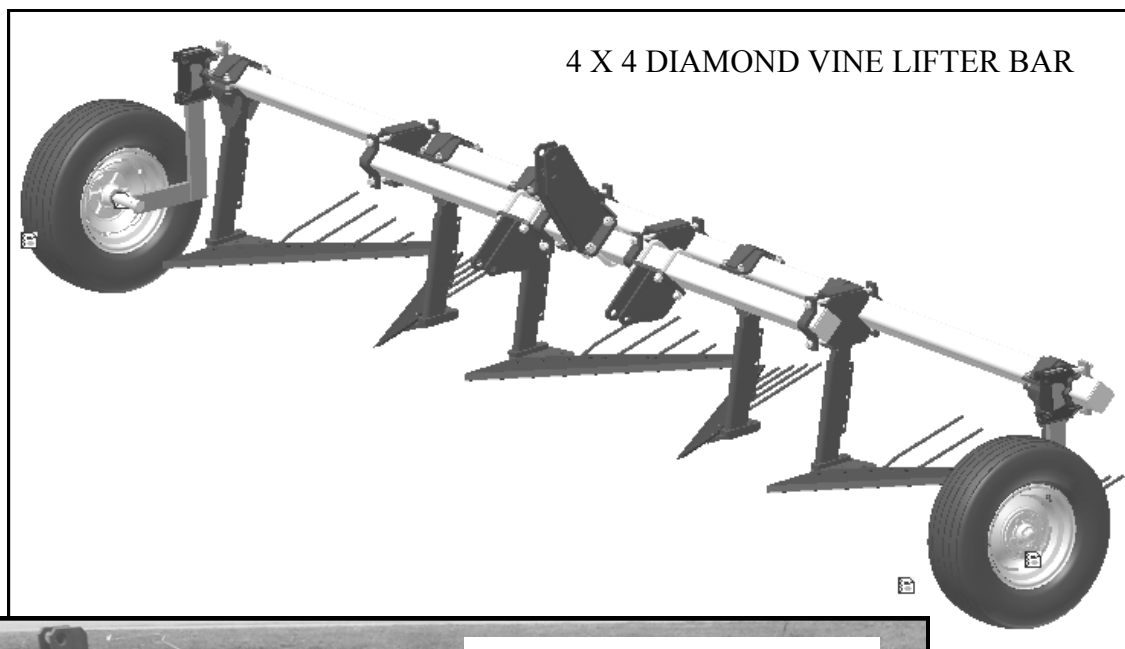

## **STORAGE TIPS FOR MACHINE**

1. Wash machine clean of dirt and vines.
2. Pour light coat of used motor oil on plow blades to protect from rust during storage.
3. Store machine under a shed where it will be kept dry and protected from direct contact with the elements.

# **PARTS BOOK SECTION**



## 4 X 4 DIAMOND VINE LIFTERS

### 2-ROW VINE LIFTER MODEL 03-2L

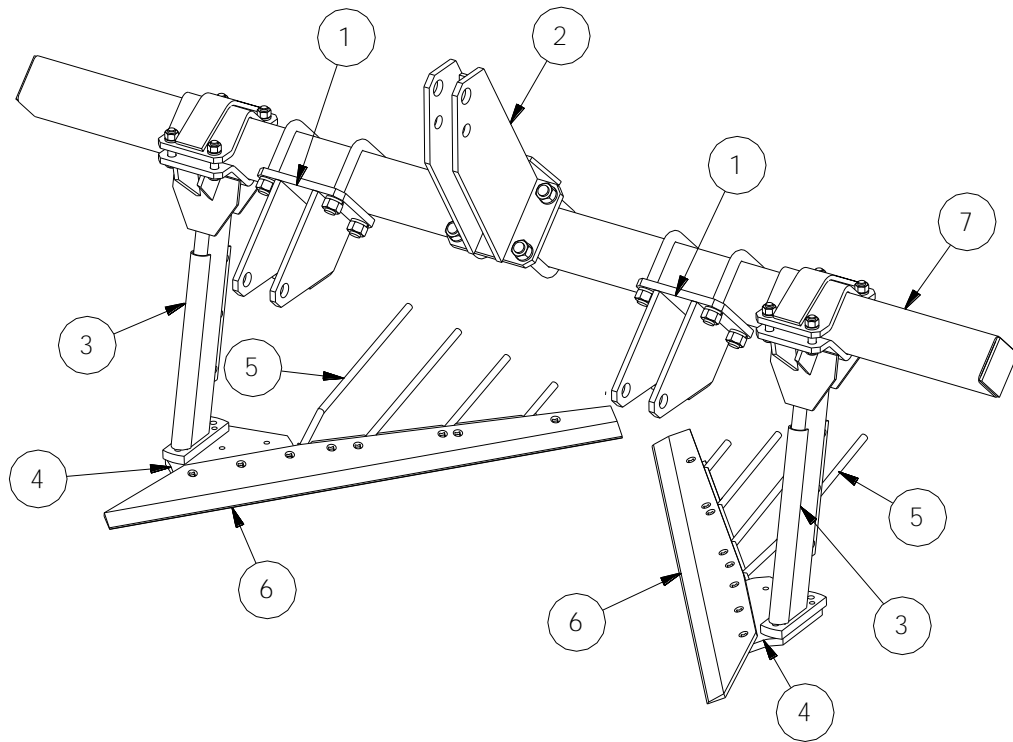

ITEM	PART NO,	DESCRIPTION	QTY	REFER TO PAGE
1	03-082-181	HITCH, VINE LIFTER	1	24
2	03-082-182	MAST, VINE LIFTER	1	24
3	-	STANDARD, PLOW	2	32
4	-	FROG, 26" CUT	1	34
5	-	CUT RODS, 26"	1	35
6	-	BLADES, 3/8 X 5 X 42"	1	35
7	04-080-030	TOOL BAR, 4 X 4 X 90"	1	25

## 6-ROW DOUBLE BAR VINE LIFTER MODEL 03-6L

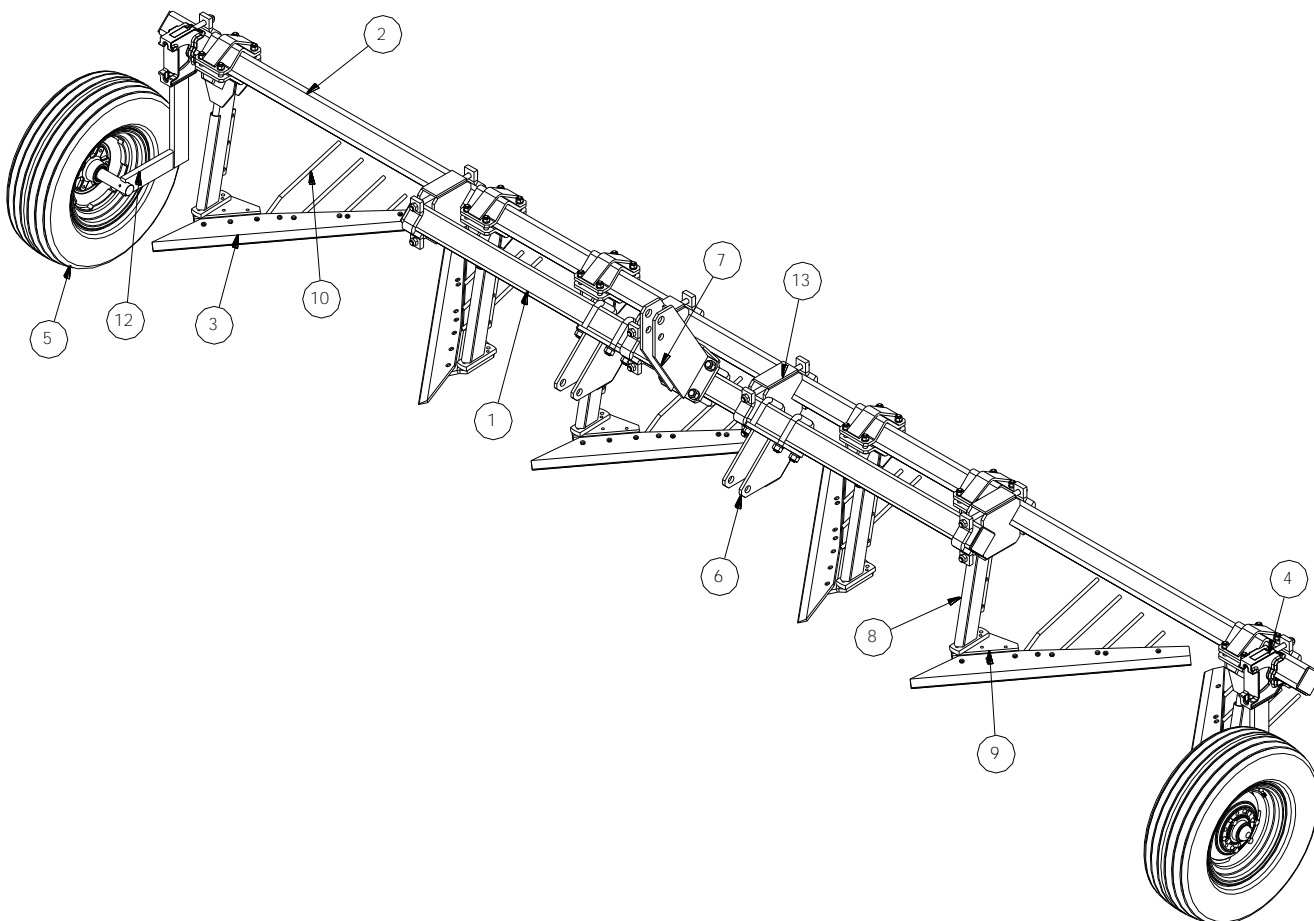

ITEM	PART NO,	DESCRIPTION	QTY	REFER TO PAGE
1	03-070-048	TOOL BAR, 4 X 4 X 120"	1	27
2	03-080-988	TOOL BAR, 4 X 4 X 240"	1	27
3	-	BLADES, 3/8 X 5 X 42"	3	35
4	04-082-056	SHANK BRACKET, 1 X 3	2	36
5	55-082-026	TIRE & RIM, 9.5L-15	2	39
6	03-082-181	HITCH, VINE LIFTER	1	24
7	03-082-182	MAST, VINE LIFTER	1	24
8	-	STANDARD, PLOW	6	32
9	-	FROG, 26" CUT	3	34
10	-	CUT RODS, 26"	3	35
11	04-082-112	REFLECTOR, SAFETY	1	40
12	03-082-326	WHEEL, 1 X 3 GAUGE	1	38
13	03-082-300	BRACKET, DB VINE LIFTER	4	25

## 2R & 6R VINE LIFTERS TOOL BARS AND HITCHES FOR 4 X 4 ◇ BARS

**LOWER HITCH-VINE LIFTER**  
(03-082-181)

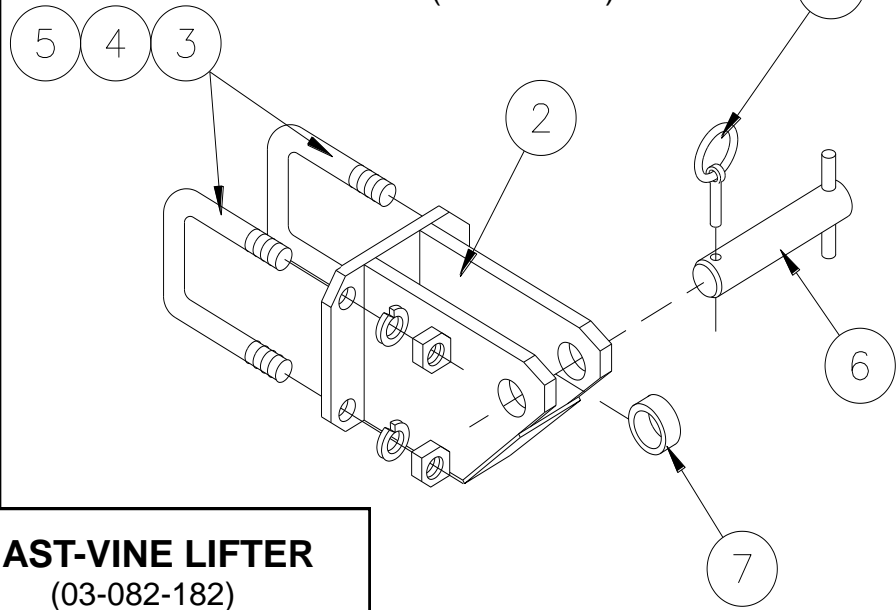

**MAST-VINE LIFTER**  
(03-082-182)

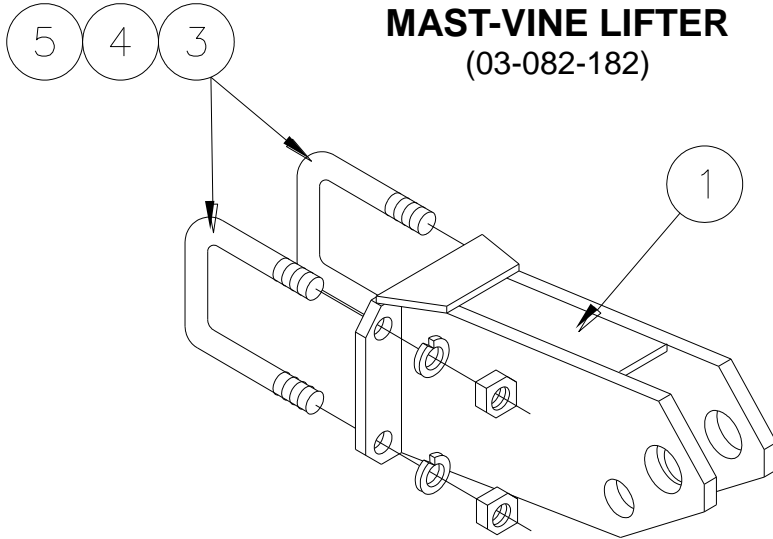

ITEM	PART NO,	SERIAL NO. OR YR.	DESCRIPTION	QTY	
				-182	-181
1	03-080-529		MAST, VINE LIFTER	1	-
2	03-080-528		LOWER HITCH, VINE LIFTER	-	2
3	14-050-018		"U" BOLTS, 7/8 X 5 3/4 X 4 15/16	2	4
4	66-010400		LOCKWASHER, 7/8 PLT	4	8
5	68-010400		HEX NUT, 7/8 PLT	4	8
6	03-050-088		HITCH PIN ,1 1 /8	-	2
7	06-024-021		SPACER, CAT II	-	2
8	02-050-002		KLICK PIN	-	2

## VINE LIFTER TOOL BAR

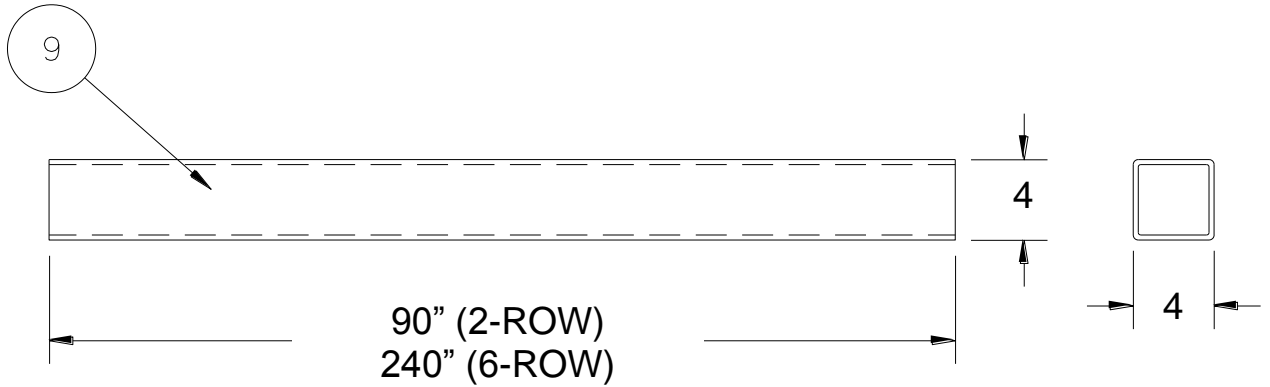

ITEM	PART NO,	SERIAL NO. OR YR.	DESCRIPTION	QTY	
				2R	4R
9	04-080-030		TOOL BAR, 4 X 4 X 90"	1	-
	03-070-048		TOOL BAR, 4 X 4 X 120" FRONT BAR	-	1
	03-080-988		TOOL BAR, 4 X 4 X 240" REAR BAR	-	1

## DB VINE LIFTER BRACKET (03-082-300)

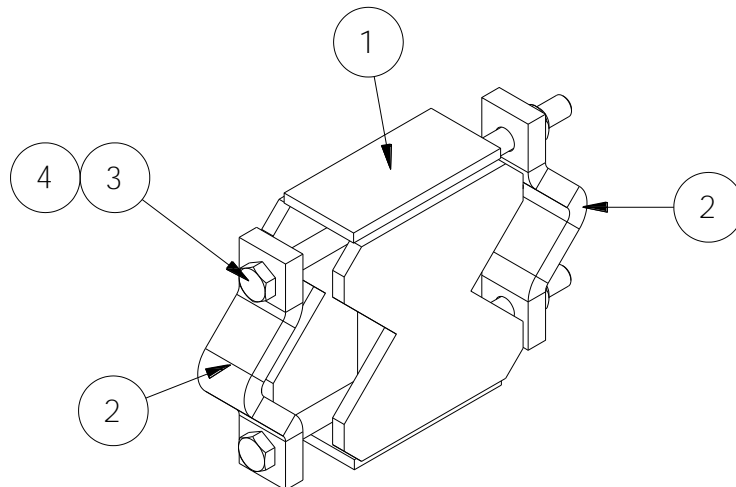

ITEM	PART NO,	SERIAL NO. OR YR.	DESCRIPTION	QTY
1	03-070-047		TB BRACKET, HD VINE	1
2	02-023-167		CAP, 4" TOOL BAR CLAMP	2
3	48-100130		CAPSCREW, 3/4 X 13	2
4	72-010150		LOCKNUT, 3/4 STOVER	2

## 5 X 5 VINE LIFTERS

### MODEL 03-2RVL

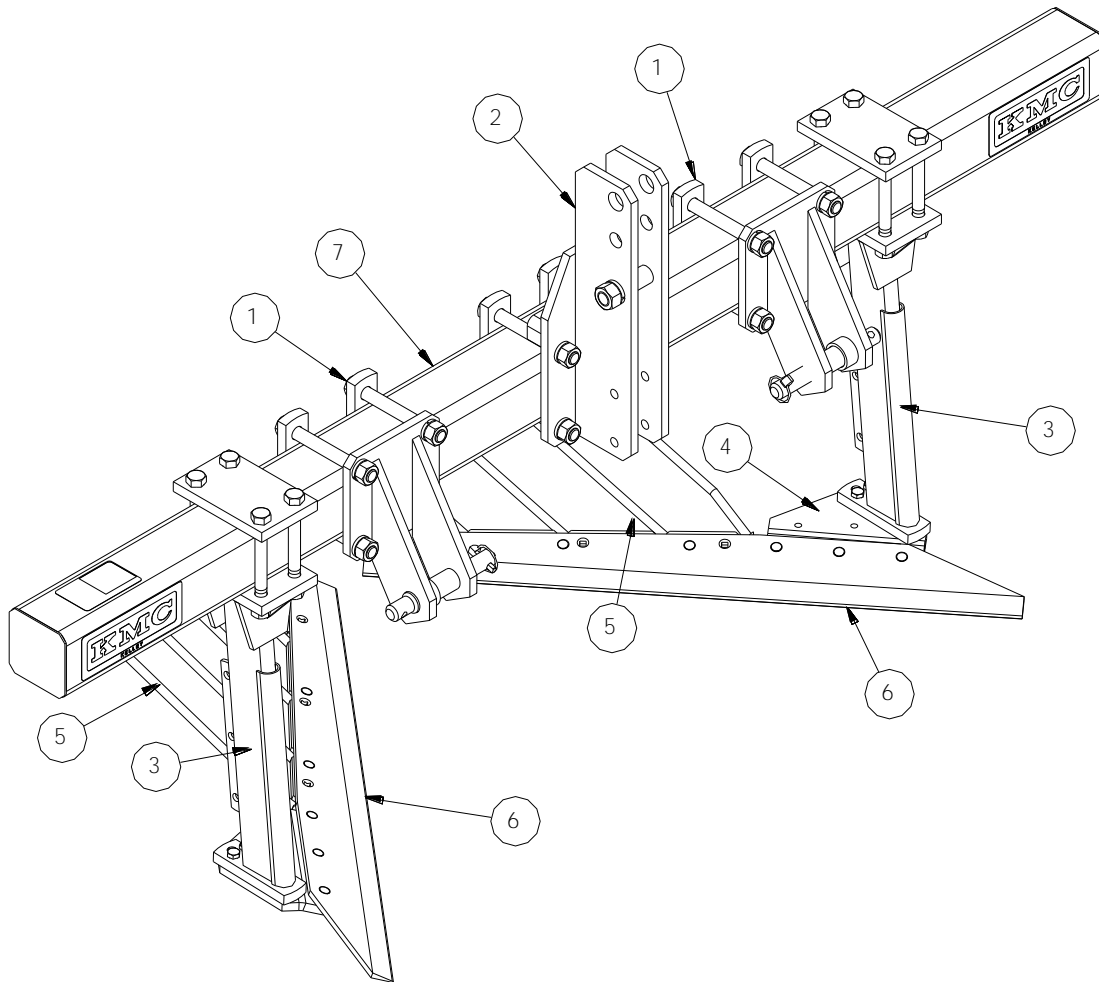

ITEM	PART NO,	DESCRIPTION	QTY	REFER TO PAGE
1	04-082-269	HITCH, 5 X 5 BOLT-ON	1	31
2	04-082-270	MAST, 5 X5 BOLT-ON	1	30
3	-	STANDARD, PLOW	2	33
4	-	FROG, 26" CUT	1	34
5	-	CUT RODS, 26"	1	35
6	-	BLADES, 3/8 X 5 X 42"	1	35
7	03-070-059	TOOL BAR, 5 X 5 X 93 3/16	1	31



## MODELS 03-6R(30)VL & 03-6R(36-40)VL

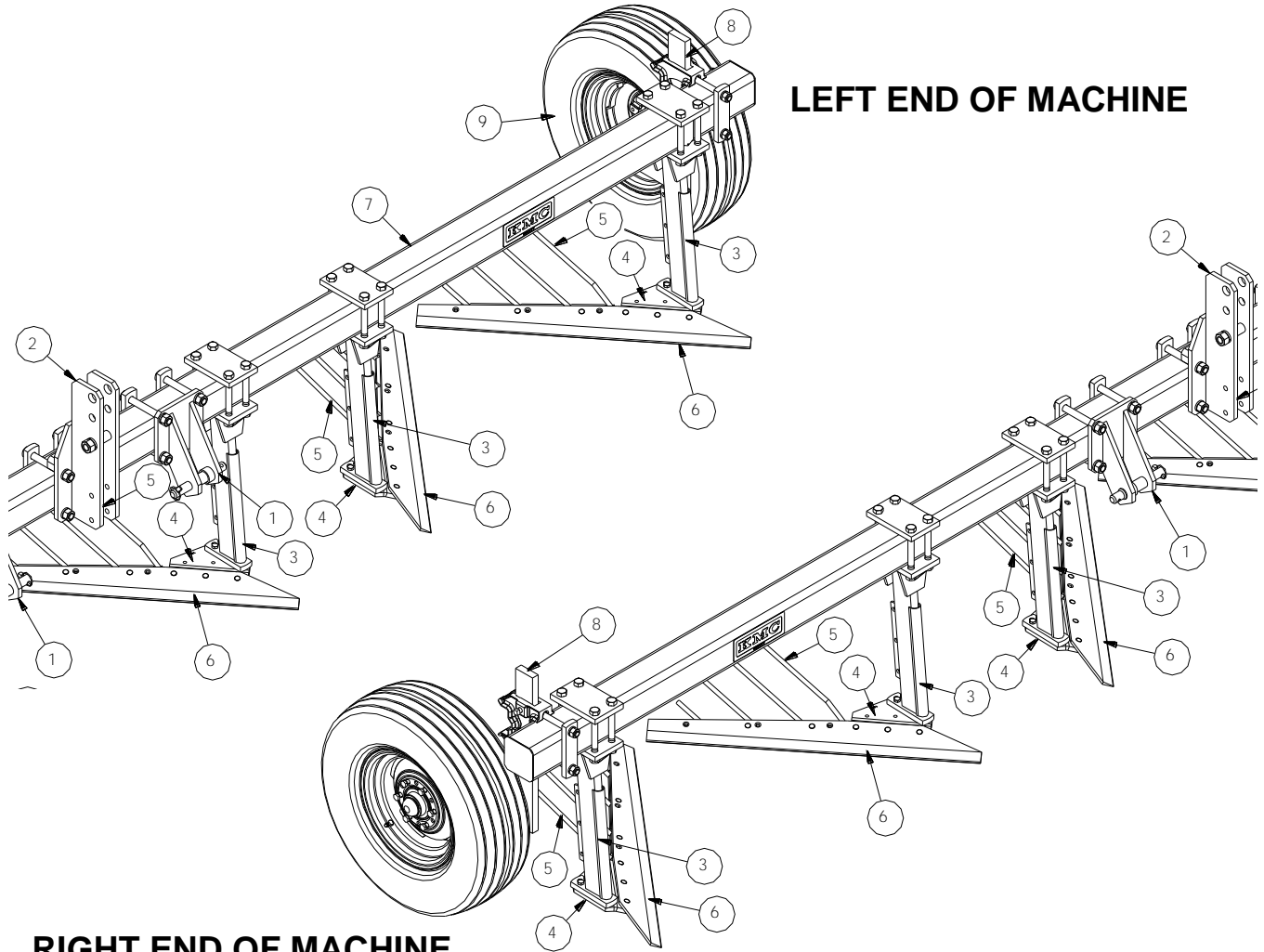

**LEFT END OF MACHINE**

**RIGHT END OF MACHINE**

ITEM	PART NO,	DESCRIPTION	QTY	REFER TO PAGE
1	04-082-269	HITCH, 5 X 5 BOLT-ON	1	31
2	04-082-270	MAST, 5 X5 BOLT-ON	1	30
3	-	STANDARD, PLOW	2	33
4	-	FROG, 26" CUT	1	34
5	-	CUT RODS, 26"	1	35
6	-	BLADES	1	35
7	03-070-058	TOOL BAR, 5 X 5 X 195 15/16 (30)	1	31
	03-070-057	TOOL BAR, 5 X 5 X 240 (36-40)	1	31
8	04-082-076	1 X 3 SHANK GAUGE WHEEL ARMS	1	38
9	55-082-026	TIRE AND RIM ASSEMBLY	2	39
10	04-082-112	REFLECTOR, SAFETY	1	40

## MODEL 03-8(30)VL

### LEFT END OF MACHINE

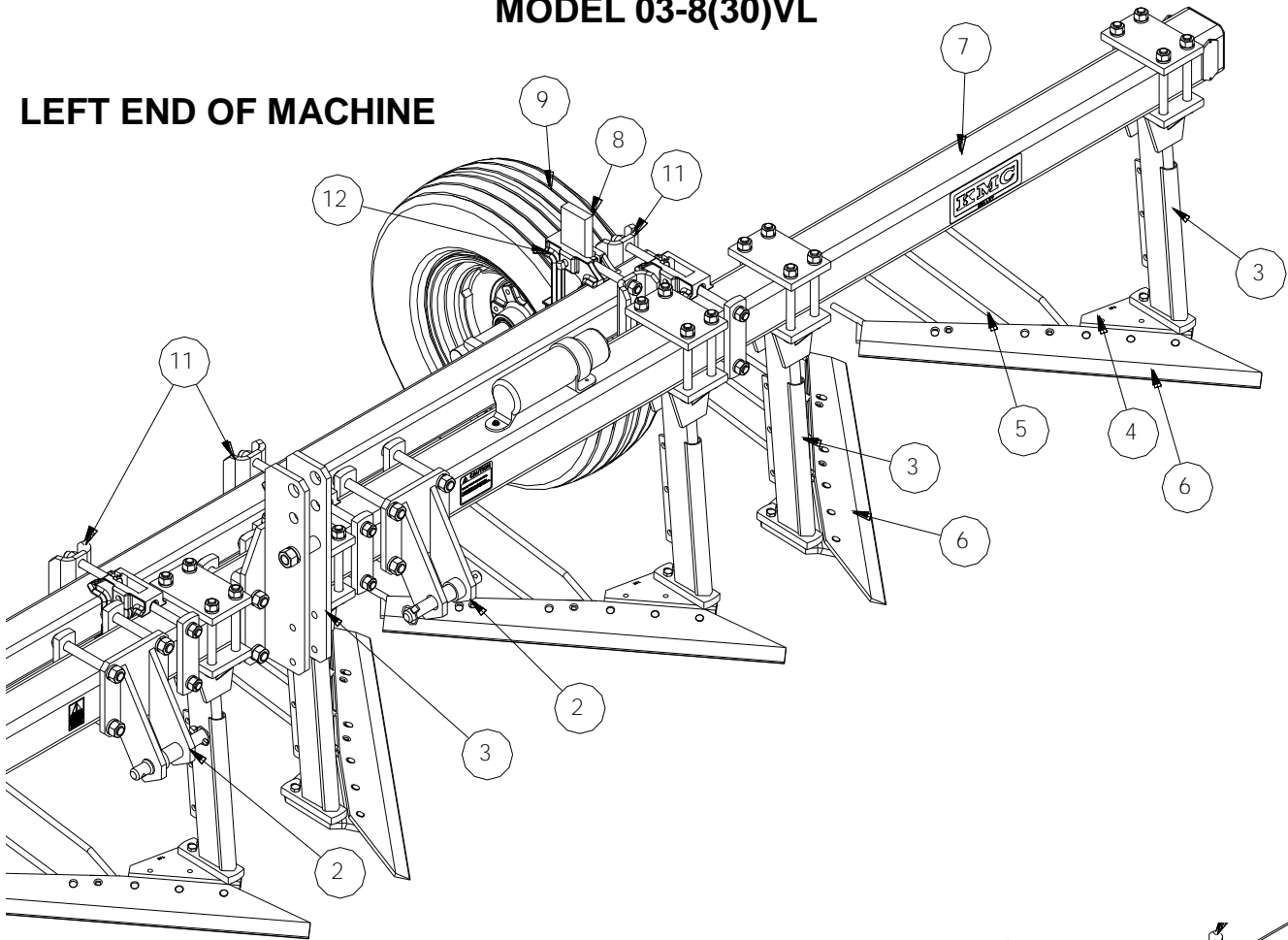

### RIGHT END OF MACHINE

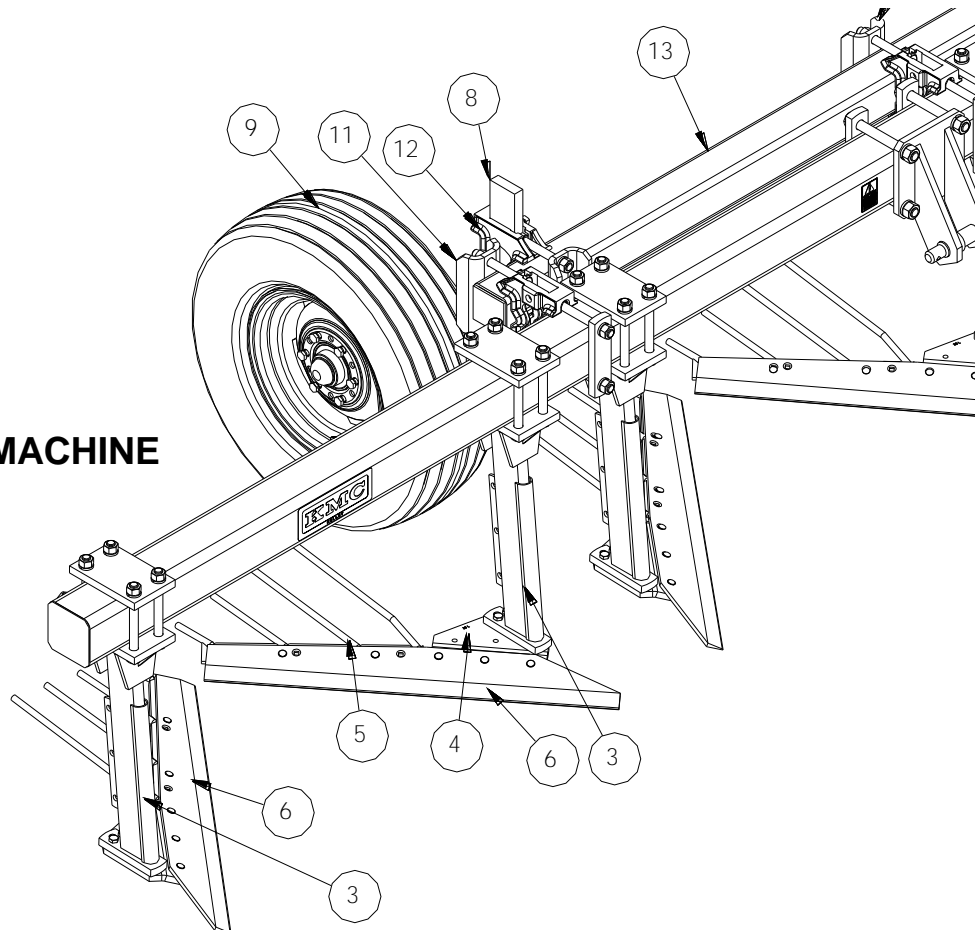

ITEM	PART NO,	DESCRIPTION	QTY	REFER TO PAGE
1	04-082-269	HITCH, 5 X 5 BOLT-ON	1	31
2	04-082-270	MAST, 5 X5 BOLT-ON	1	30
3	-	STANDARD, PLOW	8	33
4	-	FROG, 26" CUT	8	34
5	-	CUT RODS, 26"	8	35
6	03-081-250	BLADES	4 PR	35
7	03-070-057	TOOL BAR, 5 X 5 X 240 (36-40)	1	31
8	03-082-326	1 X 3 SHANK GAUGE WHEEL ARMS	2	40
9	55-082-026	TIRE AND RIM ASSEMBLY	2	41
10	04-082-112	REFLECTOR, SAFETY	1	42
11	03-082-351	BRACKET, 5 X 5 TO 4 X 4	4	38
12	04-082-267	BRACKET, (4X4) 1X3 SHANK	2	37
13	03-070-048	TOOL BAR, 120"	1	31

## 2R, 6R & 8R VINE LIFTER TOOL BARS AND HITCHES FOR 5 X 5 BARS

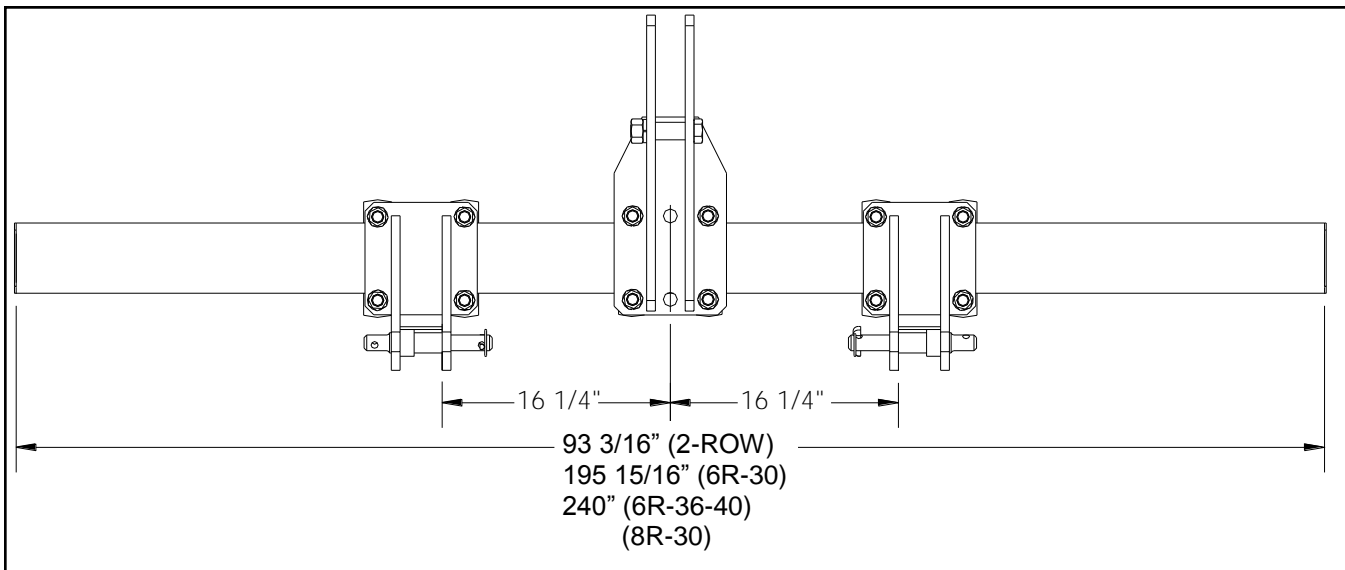
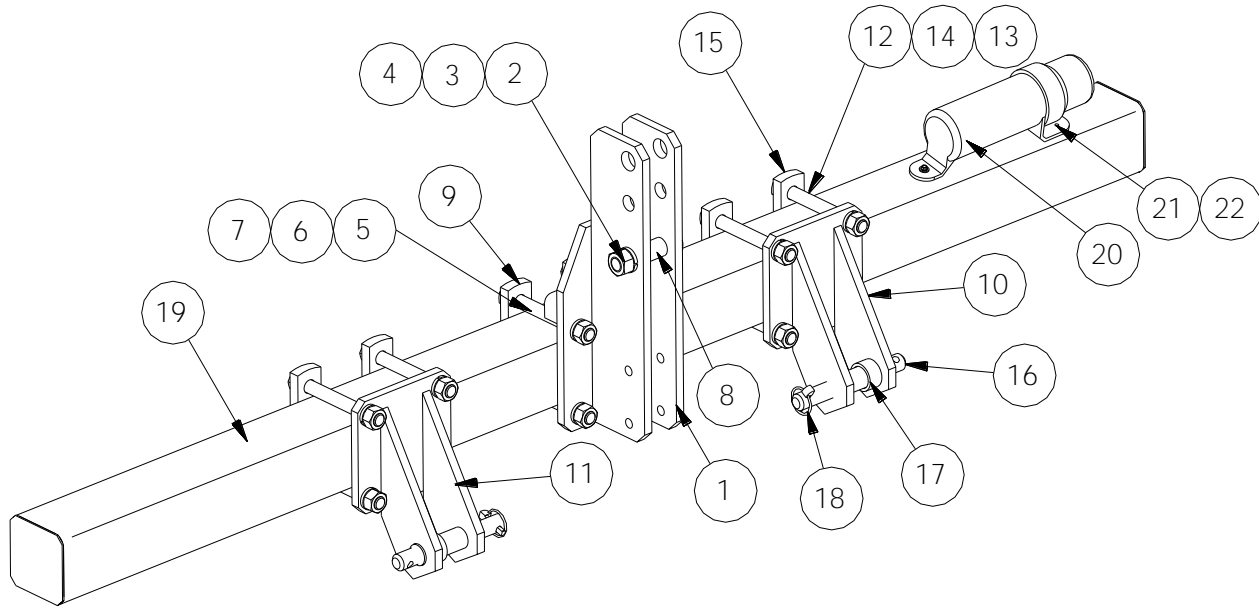

### (5 X 5) BOLT-ON MAST (04-082-270)

ITEM	PART NO,	SERIAL NO. OR YR.	DESCRIPTION	QTY
1	20-080-109		MAST, (5X5) BOLT-ON	1
2	68-010450		HEX NUT, 1 PLT	1
3	66-010450		LOCKWASHER, 1 PLT	1
4	48-100550		CAPSCREW, 1 X 4 1/2 G5 PLT	1
5	48-100325		CAPSCREW, 7/8 X 7 1/2 G5 PLT	4

ITEM	PART NO,	SERIAL NO. OR YR.	DESCRIPTION	QTY
6	66-010400		LOCKWASHER, 7/8 PLT	4
7	68-010400		HEX NUT, 7/8 PLT	4
8	02-024-004		SPACER, 8 X 10	1
9	20-023-113		CAP, 5 X 5	2

**(5 X 5) BOLT-ON HITCH  
(04-082-269)**

ITEM	PART NO,	SERIAL NO. OR YR.	DESCRIPTION	QTY
10	20-080-110		HITCH (5X5) LT LOWER	1
11	20-082-111		HITCH (5X5) LT LOWER	1
12	48-100325		CAPSCREW, 7/8 X 7 1/2 G5 PLT	8
13	66-010400		LOCKWASHER, 7/8 PLT	8
14	68-010400		HEX NUT, 7/8 PLT	8
15	20-023-113		CAP, 5 X 5	4
16	04-026-025		PIN, SHORT STEP HITCH	2
17	06-024-022		SPACER, CAT III	2
18	02-050-002		KLIK PIN, 7/16 X 1 3/4	2

**5 X 5 TOOL BAR**

ITEM	PART NO,	SERIAL NO. OR YR.	DESCRIPTION	QTY
19	03-070-059		TOOL BAR, 5 X 5 X 93 3/16 (2-ROW)	1
	03-070-058		TOOL BAR, 5 X 5 X 195 15/16 (6R-30)	1
	03-070-057		TOOL BAR, 5 X 5 X 240 (6R-36-40)	1
	03-070-057		TOOL BAR, 5 X 5 X 240 (8R-30)	1

ITEM	PART NO,	SERIAL NO. OR YR.	DESCRIPTION	QTY
20	49-050-012		CANISTER, MANUAL PROTECTION	1
21	80-080000		SCREW, #12 X 1 HEX SELF DRILL	2
22	62-010010		FLATWASHER, 1/4 STD PLT	2

## PLOW STANDARDS

### 4 X 4 SHANKS

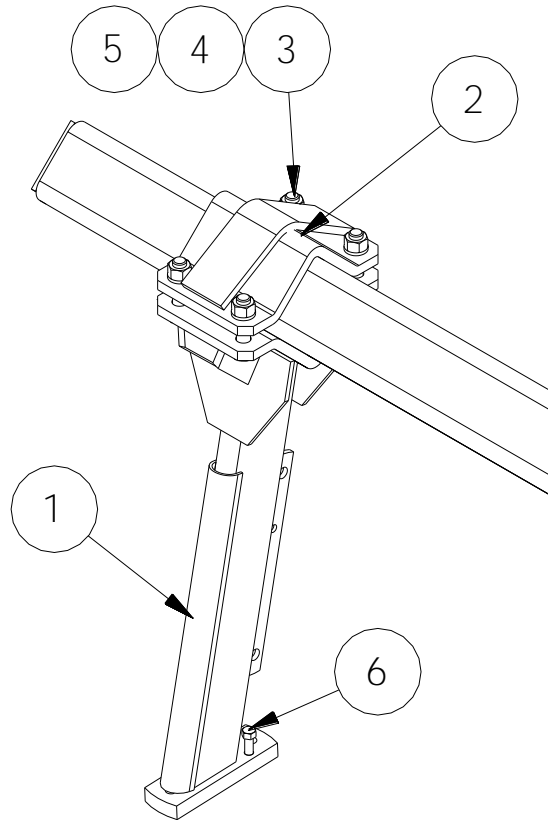

ITEM	PART NO.	SERIAL NO. OR YR.	DESCRIPTION	QTY			
				2R	6R 30	6R 36-40	8R 30
1	03-080-224		STANDARDS, PLOW	2	6	6	8
2	03-080-560		CLAMP, PLOW STD.	2	6	6	8
3	48-090985		CAPSCREW, 5/8 X 2 3/4	8	24	24	32
4	66-010300		LOCKWASHER, 5/8 PLT	8	24	24	32
5	68-010300		HEX NUT, 5/8 PLT	8	24	24	32
6	48-090590		CAPSCREW, 1/2 X 1	4	12	12	16

## 5 X 5 SHANKS

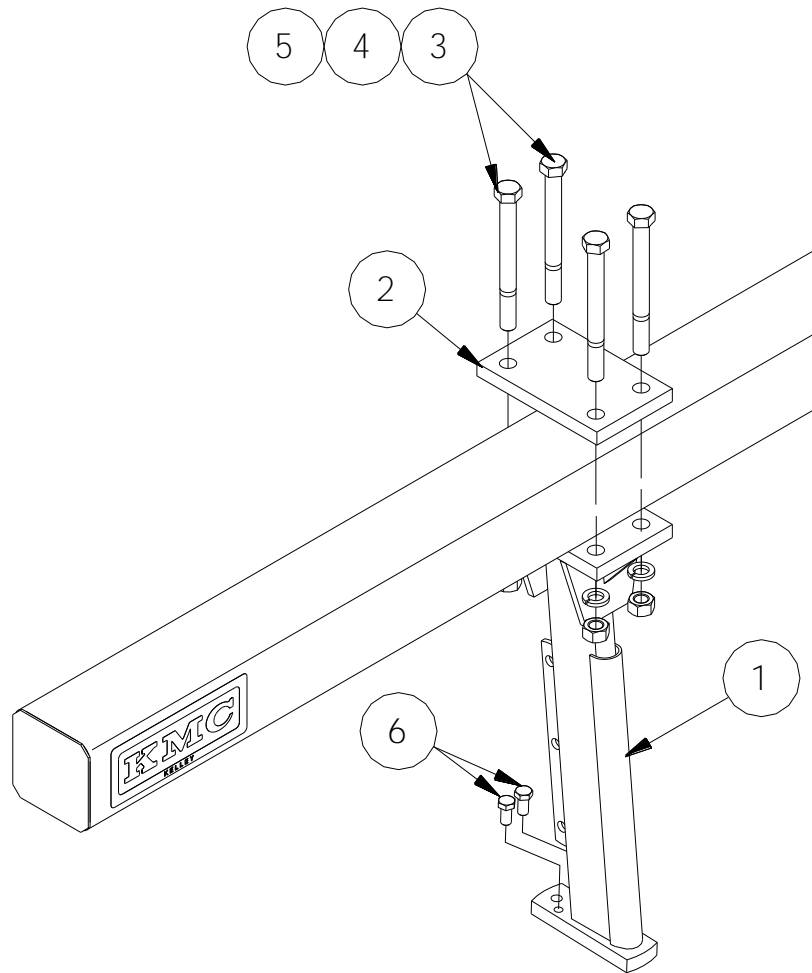

ITEM	PART NO,	SERIAL NO. OR YR.	DESCRIPTION	QTY			
				2R	6R 30	6R 36-40	8R 30
1	03-080-605		WELDMENT, SHANK	2	6	6	8
2	03-023-673		CAP, SHANK	2	6	6	8
3	48-100075		CAPSCREW, 3/4 X 7 1/2	8	24	24	32
4	66-010350		LOCKWASHER, 3/4 PLT	8	24	24	32
5	68-010350		HEX NUT, 3/4 PLT	8	24	24	32
6	48-090590		CAPSCREW, 1/2 X 1	4	12	12	16

## 26" FROGS

### 4 X 4 & 5 X 5 BARS

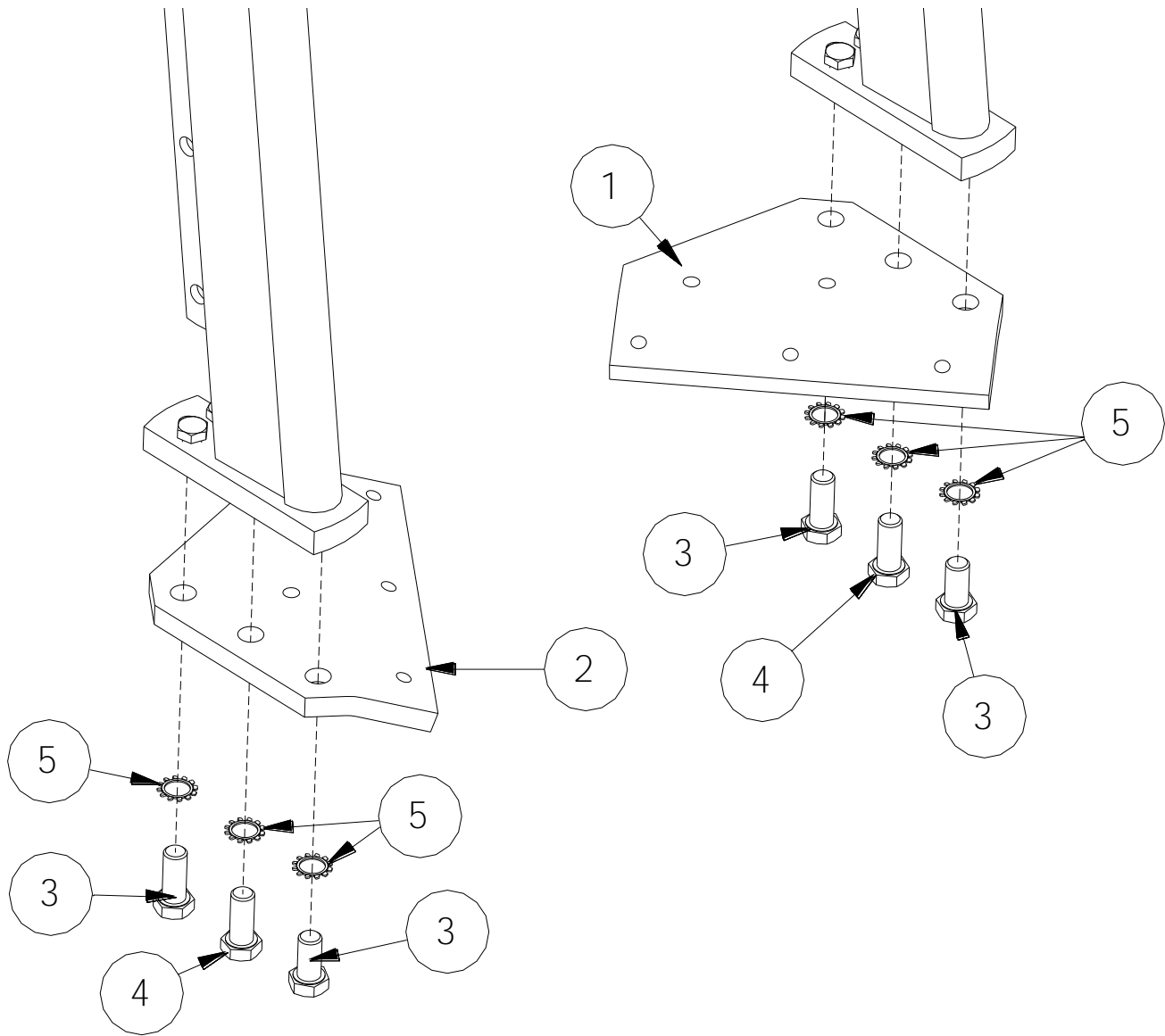

ITEM	PART NO.	SERIAL NO. OR YR.	DESCRIPTION	QTY			
				2R	6R 30	6R 36-40	8R 30
1	03-023-533		FROG, LT 26"	1	3	3	4
2	03-023-534		FROG, RT 26"	1	3	3	4
3	48-090930		CAPSCREW, 5/8 X 1 1/2	4	12	12	16
4	48-090910		CAPSCREW, 5/8 X 1 1/4	2	6	6	8
5	66-010595		LOCKWASHER, 5/8 EXT	6	18	18	24



## BLADES & CUT RODS

### 4 X 4 & 5 X 5 BARS

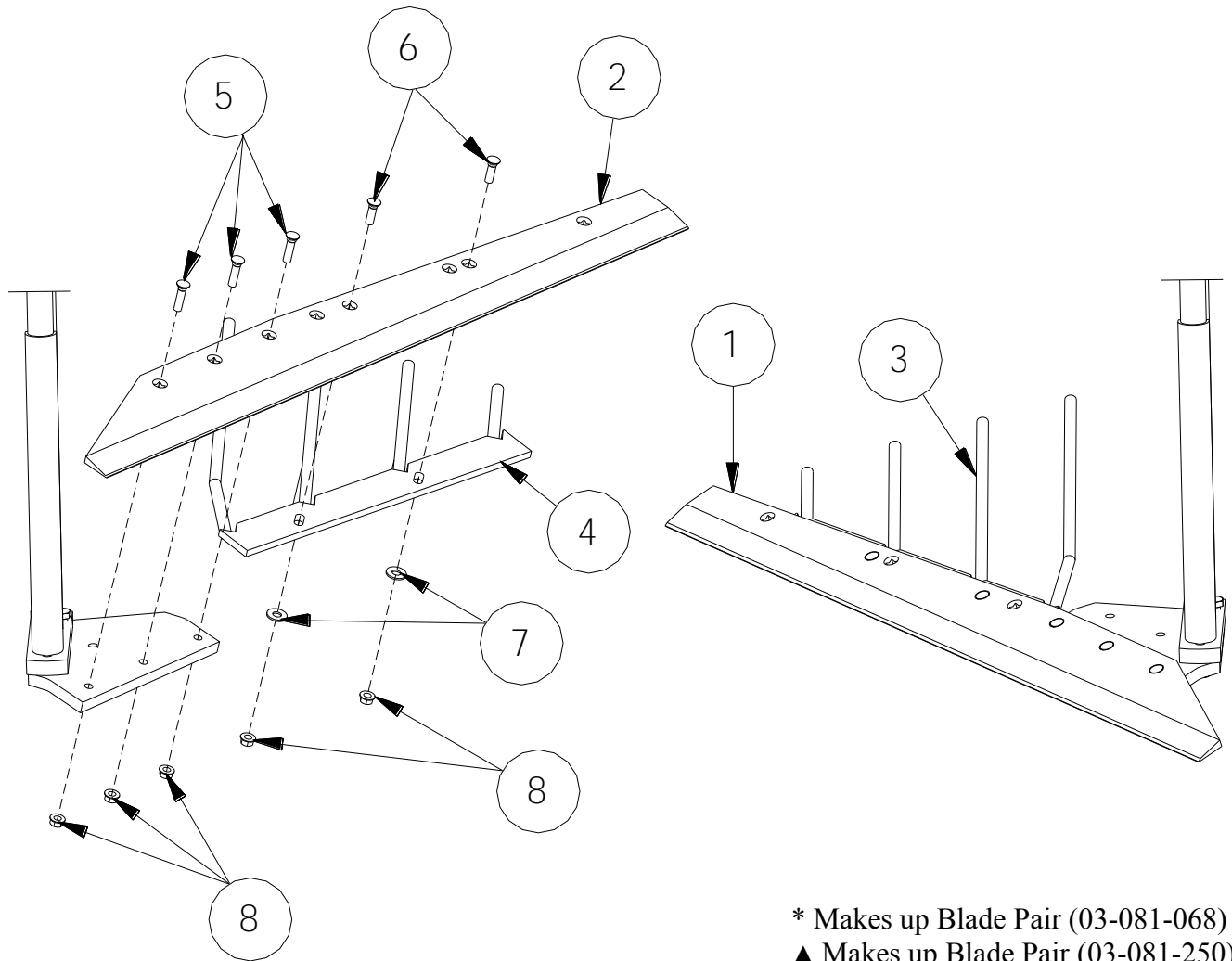

\* Makes up Blade Pair (03-081-068)

▲ Makes up Blade Pair (03-081-250)

ITEM	PART NO.	SERIAL NO. OR YR.	DESCRIPTION	QTY			
				2R	6R 30	6R 36-40	8R 30
1 *	03-050-014		BLADE, LT 3/8X5X42"	1	-	3	-
▲	03-050-203		BLADE, LT 3/8X5X36"	-	3	-	4
2 *	03-050-015		BLADE, RT 3/8X5X42"	1	-	3	-
▲	03-050-204		BLADE, RT 3/8X5X36"	-	3	-	4
3	03-080-071		CUT ROD, LT 26"	1	3	3	4
4	03-080-072		CUT ROD, RT 26"	1	3	3	4
5	60-020065		PLOWBOLTS, 3/8 X 1 1/2	6	18	18	24
6	60-020050		PLOWBOLTS, 3/8 X 1 1/4	4	12	12	16
7	62-010100		FLATWASHER, 3/8 STD	4	12	12	16
8	78-020300		WHIZ NUT, 3/8	10	30	30	40

## GAUGE WHEEL COMPONENTS

### 1 X 3 SHANK BRACKET, 4 X 4 ◇ (04-082-056)

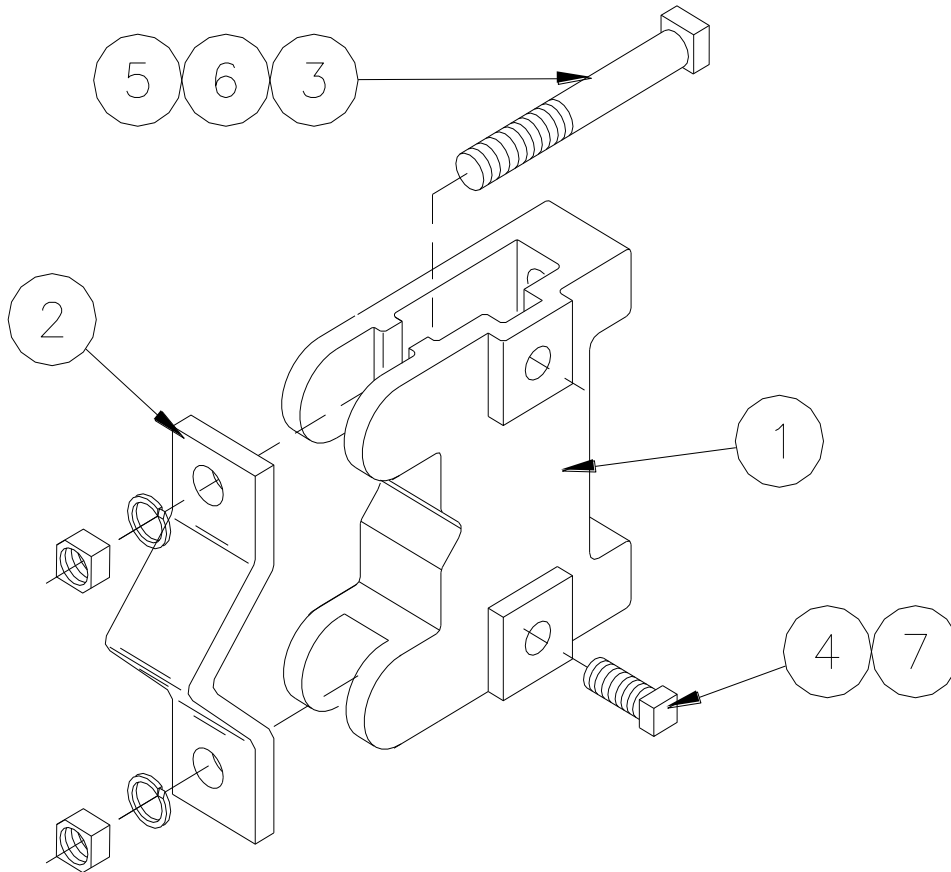

ITEM	PART NO,	SERIAL NO. OR YR.	DESCRIPTION	QTY
1	04-057-027		BRACKET, 1 X 3 SHANK	1
2	02-023-167		CLAMP CAP	1
3	66-010350		HEX NUT, 3/4 PLT	2
4	54-010300		SETSCREW, 5/8 X 1 1/2 SQ HS CUPPT	2
5	50-010150		CAPSCREW, 3/4 X 5 SQ HS G5 PLT	2
6	66-010350		LOCKWASHER, 3/4 PLT	2
7	74-010100		SQUARE NUT, 5/8	2

**1 X 3 SHANK BRACKET, 4 X 4**  
**(04-082-267)**

**1 X 3 SHANK BRACKET, 5 X 5**  
**(03-082-304)**

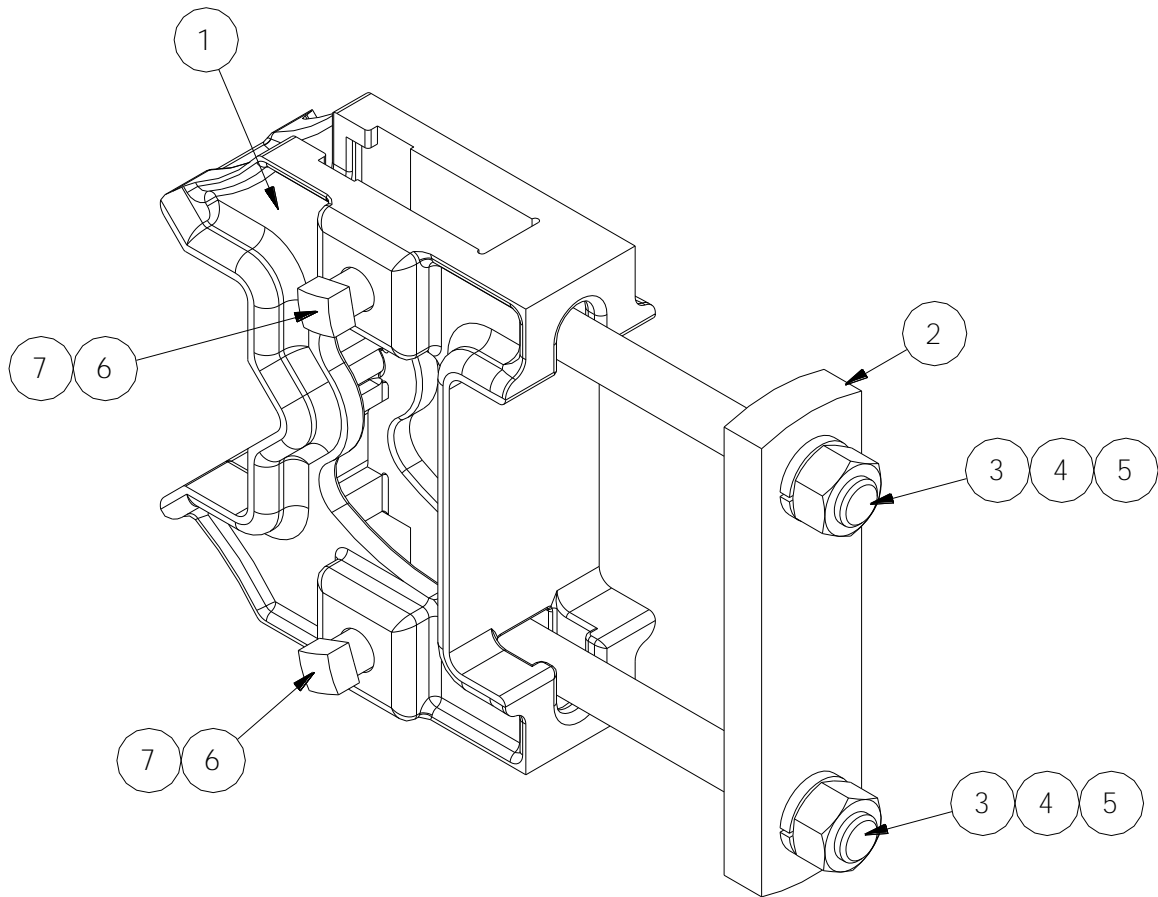

ITEM	PART NO,	SERIAL NO. OR YR.	DESCRIPTION	QTY	
				4X4	5X5
1	04-057-027		1X3 SHANK BRACKET CASTING	1	1
2	07-023-044		CLAMP, 1X3 SHANK	1	-
	36-023-027		CLAMP, COULTER BRACKET	-	1
3	48-100025		CAPSCREW, 3/4 X 5 1/2 G5 PLT	2	-
	48-100070		CAPSCREW, 3/4 X 7 G5 PLT	-	2
4	66-010350		LOCKWASHER, 3/4 PLT	2	2
5	68-010350		HEX NUT, 3/4 PLT	2	2
6	54-010300		SETSCREW, 5/8 X 1 1/2 SQ HD	2	2
7	74-010100		SQUARE NUT, 5/8 PLN	2	2

**5 x 5 to 4 x 4 BRACKET**  
(03-082-351)

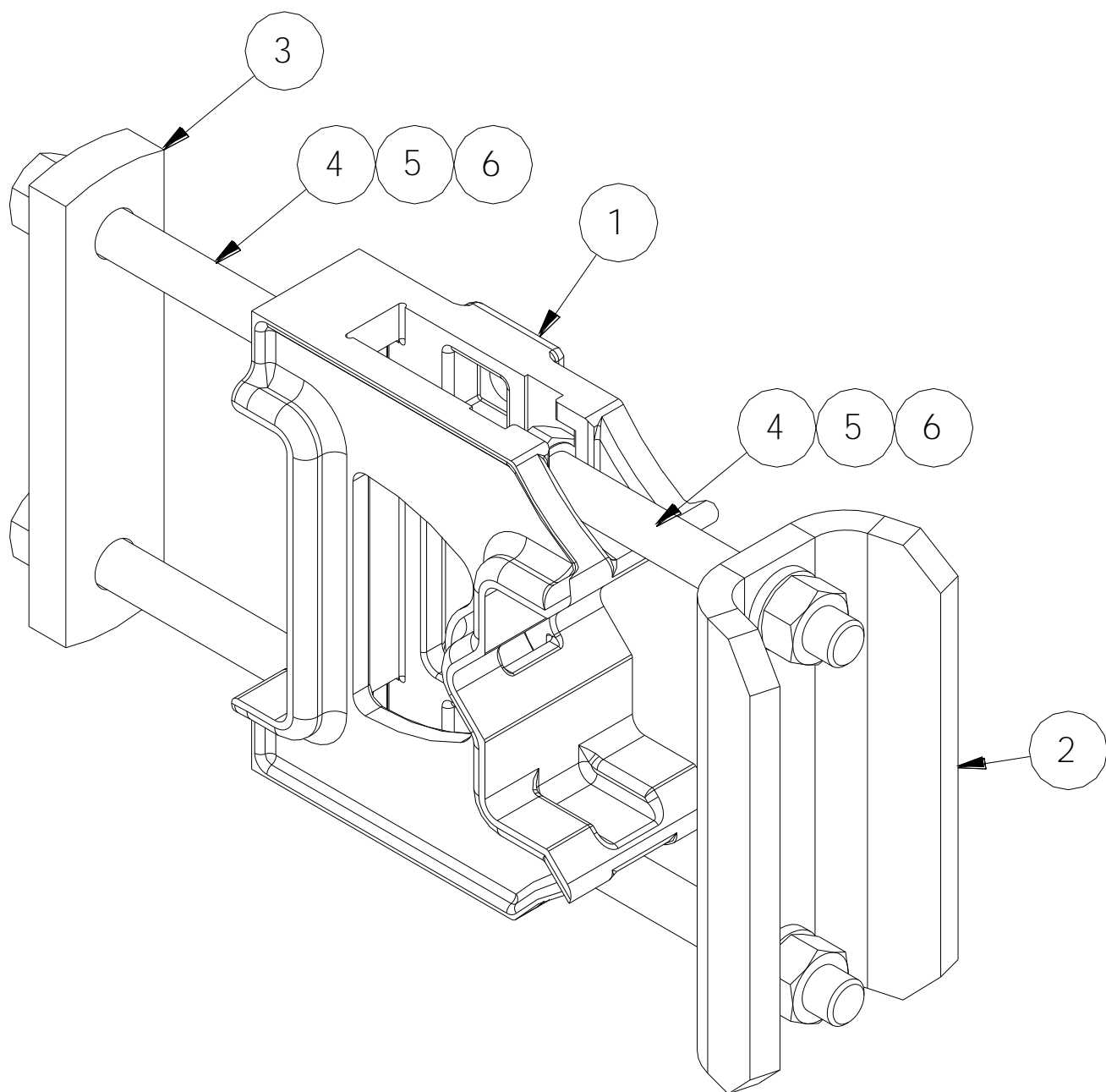

ITEM	PART NO,	SERIAL NO. OR YR.	DESCRIPTION	QTY
1	04-057-027		BRACKET, 1 X 3 SHANK	1
2	07-023-044		CLAMP, 4" & 5" TOOL BAR	1
3	36-023-027		CLAMP, COULTER BRACKET	1
4	48-100050		CAPSCREW, 3/4 X 6G5 PLT	4
5	66-010350		LOCKWASHER, 3/4 PLT	4
6	68-010350		HEXNUT, 3/4 PLT	4

BLANK  
PAGE

**LT & RT INVERTER GAUGE WHEEL ARM,  
(1 X 3 SHANK)  
(03-082-326)**

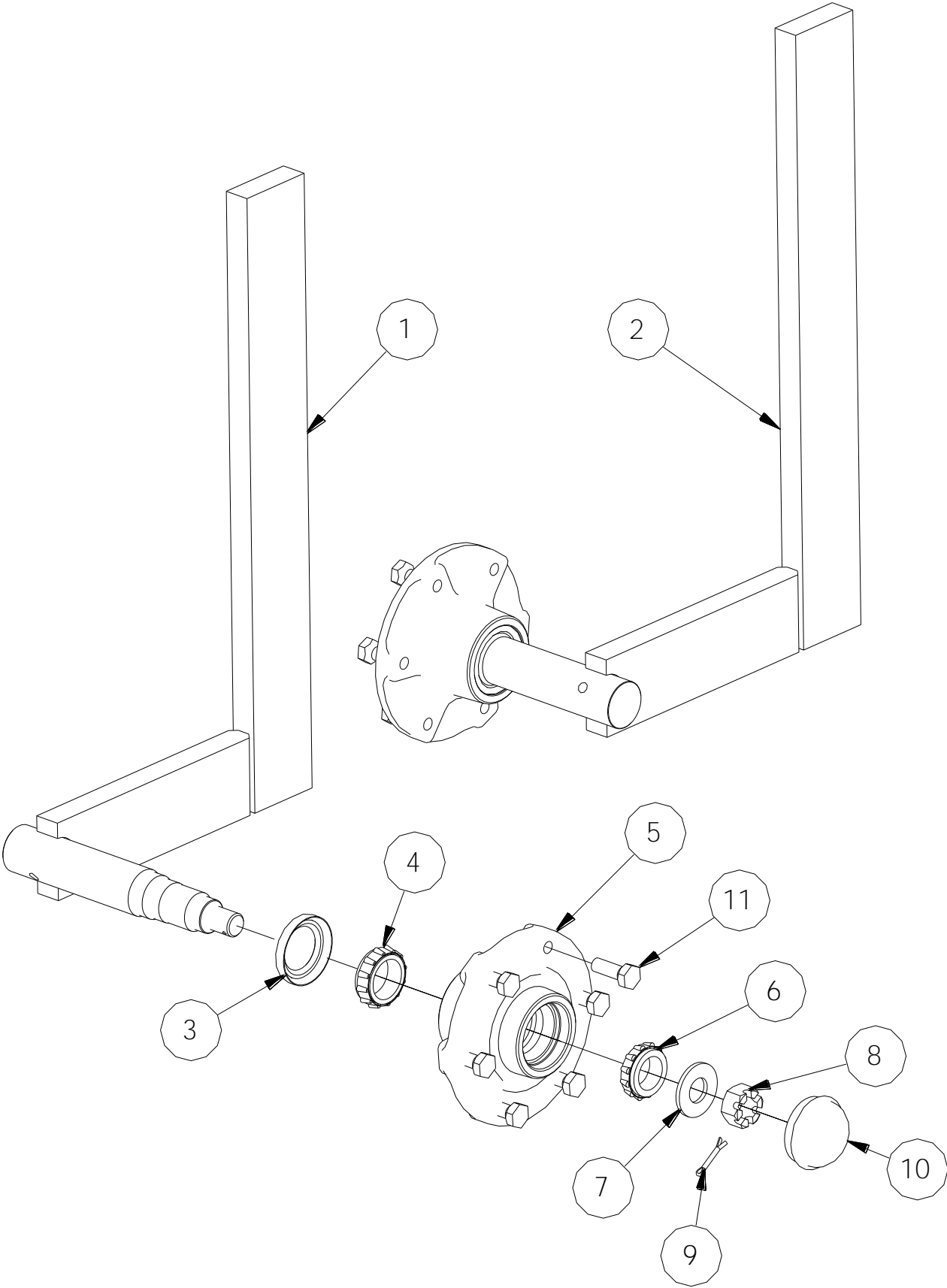

ITEM	PART NO,	SERIAL NO. OR YR.	DESCRIPTION	QTY
1	03-070-220		ARM, LT INVERTER GAUGE WHEEL	1
2	03-070-221		ARM, LT INVERTER GAUGE WHEEL	1

ITEM	PART NO,	SERIAL NO. OR YR.	DESCRIPTION	QTY	
				LT	RT
3	02-056-011		SEAL (16289CR)	1	1
4	02-051-041		INNER BEARING CONE (JL69349)	1	1
5	02-058-033		6-BOLTS HUB W/CUPS	1	1
	02-051-040		INNER BEARING CUP (JL69310)	-	-
	02-051-041		OUTER BEARING CUP (LM67010)	-	-
6	02-051-006		OUTER BEARING CONE (LM67048)	1	1
7	02-050-019		WASHER, 15/16X2X.160THK	1	1
8	68-030050		SLOTTED NUT, 7/8 N.F.	1	1
9	76-010050		COTTER PIN, 5/32 X 1 1/4	1	1
10	02-058-005		HUB CAP	1	1
11	02-058-004		WHEEL BOLT, 1/2 X 1 1/4 NF	6	6

**TIRE & RIM ASSEMBLY (9.5L-15)**  
(55-082-026)

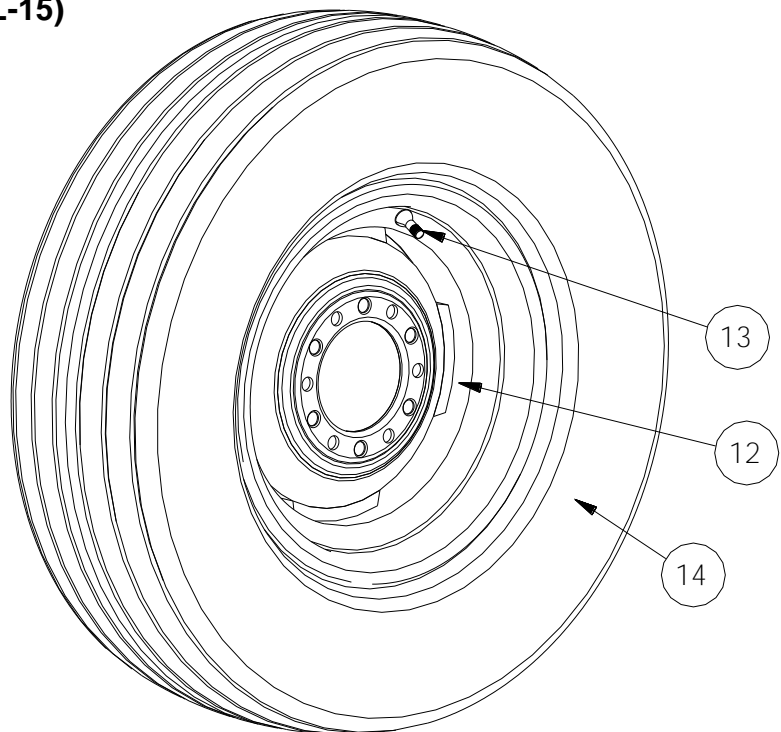

ITEM	PART NO,	SERIAL NO. OR YR.	DESCRIPTION	QTY
12	02-058-008		WHEEL, 15 X 6	1
13	18-050-021		STEM, VALVE	1
14	42-058-005		TIRE (9.5L-15SWL)	1

# SAFETY REFLECTORS

(04-082-112)

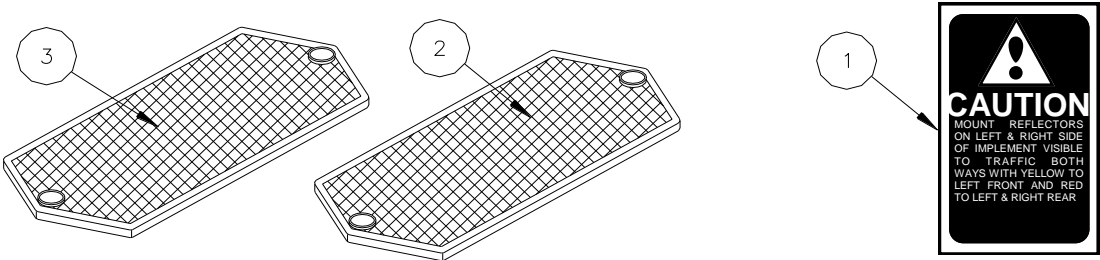

ITEM	PART NO.	SERIAL NO OR YR	DESCRIPTION	QTY
1	03-050-071		DECAL, REFLECTOR CAUTION	1
2	03-050-069		REFLECTOR, AMBER	1
3	03-050-070		REFLECTOR, RED	2



## This image shows a full page of blank, lined paper. It features approximately 28 horizontal black lines spaced evenly across the page, typical of standard notebook paper. The lines are thin and extend from the left edge to the right edge. There are no margins, text, or other markings on the page.

## NOTES

[illegible]

The following is a list of serial numbers issued to our machines at the beginning of each year. To determine when a unit was made, find the range within which the particular serial number falls. It would have been produced between January 1 to December 31 of that year.

<b>YEAR</b>	<b>SERIAL NUMBERS</b>
1985	27986-29695
1986	29696-31095
1987	31096-33234
1988	33235-35548
1989	35549-38496
1990	38497-41771
1991	41772-44466
1992	44467-47001
1993	47002-48750
1994	48751-51549
1995	51551-54262
1996	54263-56661
1997	56662-59465
1998	59466-62097
1999	62098-63986
2000	63987-65692
2001	65693-67340
2002	67341-68699
2003	68700-70482
2004	70483-72646
2005	72647-74866
2006	74867-76368
2007	76369-77883
2008	77884-79891
2009	79892-80944
2010	80945-81775
2011	81776-83453
2012	83454-85092
2013	85093-86418
2014	86419-87790
2015	87791-89096
2016	89097-90089
2017	90090-



## **DEPENDABLE EQUIPMENT FOR PROGRESSIVE FARMING**

*Visit us at [www.kelleymfg.com](http://www.kelleymfg.com)*



## **KELLEY MANUFACTURING CO.**

80 Vernon Drive / Zip 31794  
P.O. Drawer 1467 / Zip 31793  
Tifton, GA



Tel: 229-382-9393  
Toll Free: 1-800-444-5449  
Fax: 229-382-5259

Email Address: [info@kelleymfg.com](mailto:info@kelleymfg.com)